



STATE^{OF} THE COAST



Visit m.stateofthecoast.org
for more conference
information.

March 18-20, 2014

Morial Convention Center | New Orleans, LA



GRAND HALL

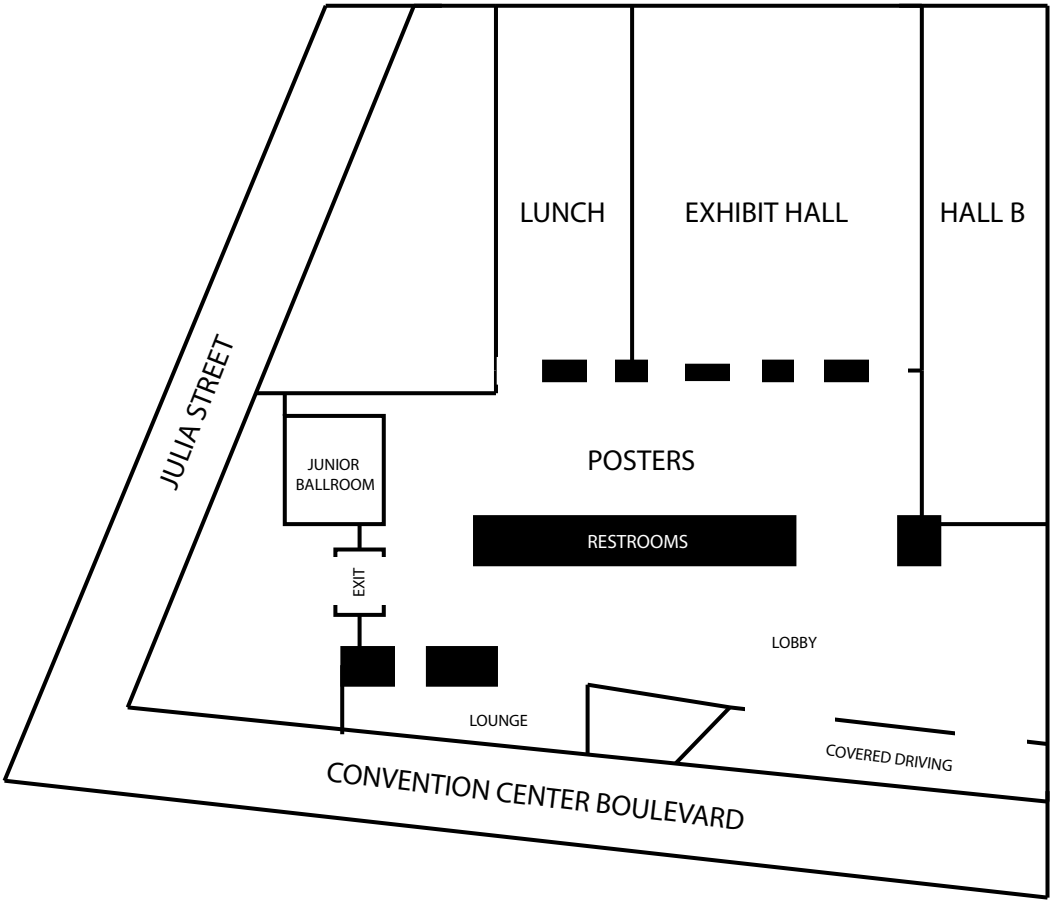

MEETING ROOMS

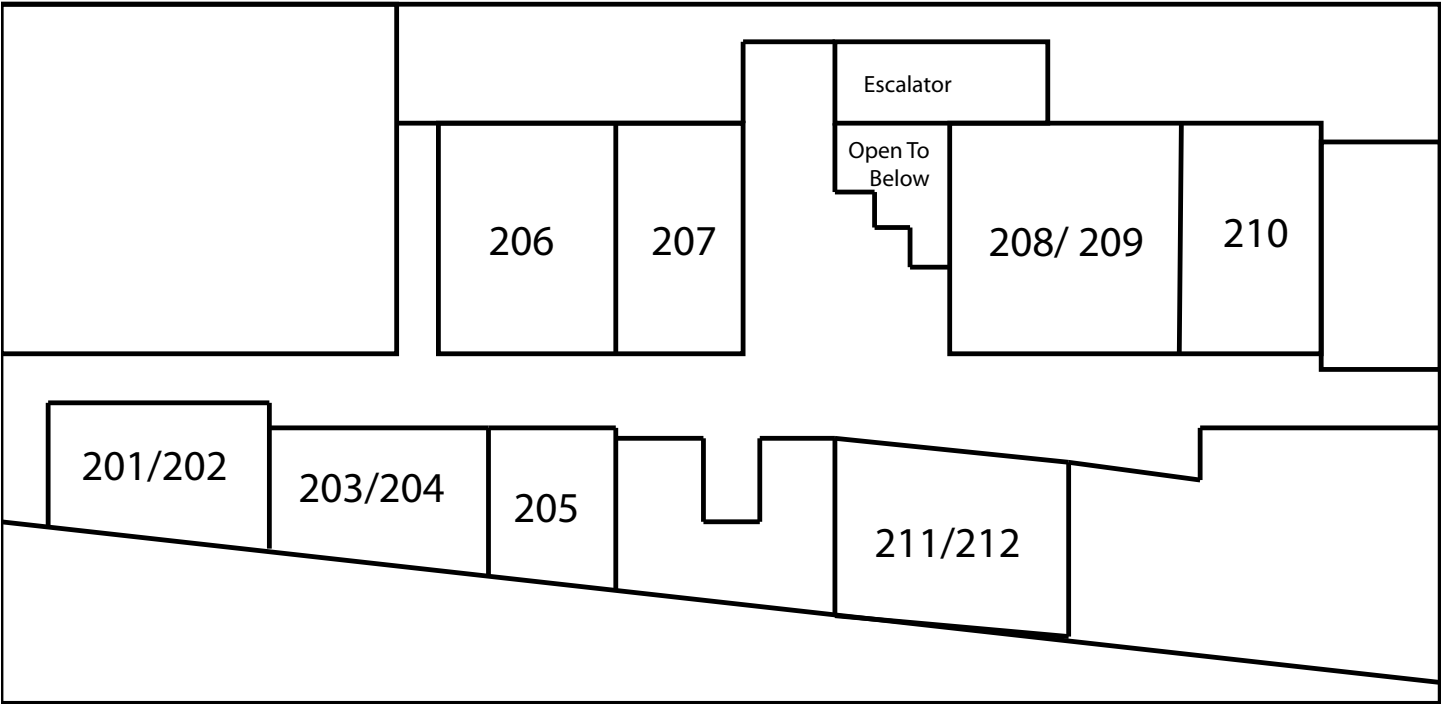

2014

State of the Coast Conference

MARCH 18-20, 2014

Morial Convention Center | New Orleans, LA

CONFERENCE PARTNERS





Diverse Partners

One Voice

Coalition to Restore Coastal Louisiana

The statewide voice of coastal restoration for over 25 years

www.CRCL.org

1-888-LACOAST



Lots of progress has been made over the last few years...
imagine what we can do over the next fifty.

Stop by Booth A or visit **coastal.la.gov** to see how
we're working to protect and restore our coast.



May 2013



December 2013

Shell Island East



2010



2013

Cameron Parish Shoreline



committed to **our coast**

CONTENTS

Speaker Bios8

Conference Schedule

 Tuesday, March 18..... 12

 Wednesday, March 19 21

 Thursday, March 20 34

 Poster Presentations 47

SOC14 Committees..... 56

Exhibitor Hall Map..... 58

Exhibitor Contact Information..... 59

Notes..... 71



SOC14 would like to thank Arc of Greater New Orleans for donating their services preparing 1000 conference totes. Arc is a 501(c) (3) non-profit organization serving people with intellectual disabilities and delays from birth through adulthood in Orleans, Jefferson and St. Bernard parishes. If you are interested in creating volunteer opportunities for special needs adults please visit their website at <http://www.arcgno.org/>



COAST & HARBOR ENGINEERING

Coastal, Navigation, Dredging & Habitat Enhancement Projects



TX 512.342.9516 FL 561.266.5752 LA 504.383.9785
www.coastharboreng.com



Mississippi River Gulf Outlet Ecosystem Restoration Study, Louisiana

Developing holistic and sustainable approaches to coastal restoration

Atkins provides design, engineering, scientific, and project management services to preserve, protect, and enhance America's coastlines.

Visit Atkins at booth #12

- Coastal habitat engineering and design
- Coastal planning
- Eco-geomorphological studies
- Ecological surveys
- Feasibility analyses
- Permitting and construction oversight

Plan Design Enable
www.atkinsglobal.com/northamerica

1.866.940.7275

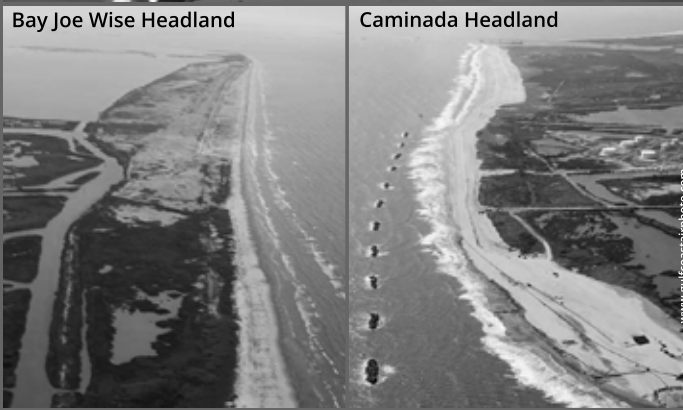

**COASTAL
ENGINEERING
CONSULTANTS
INC.**

WELCOME ADDRESS AND OPENING KEYNOTE



Tuesday 9:00 – 10:00, (Great Hall Dining Area)

9:10 – 9:25

Jerome “Z” Zeringue, Welcome Address

Executive Assistant to the Governor for Coastal Activities

Chair, Coastal Protection and Restoration Authority

Jerome Zeringue has extensive experience advocating for coastal protection and restoration matters on a federal, state and local level. Before his appointment as the governor’s executive assistant for coastal activities, he served as executive director of the CPRA, having already served that agency as deputy executive director and as a coastal activities advisor in the governor’s office.

A native of Thibodaux, he previously served as director of the Terrebonne Levee and Conservation District. He holds a bachelor’s degree in zoology and a master’s degree in fisheries biology, both from Louisiana State University. Mr. Zeringue—or Zee, as his friends call him—worked as a fisheries biologist at LSU Sea Grant and assisted the U.S. Food and Drug Administration on seafood regulations. He then became the coastal resources director for the Nature Conservancy of Louisiana, and also helped to establish the Mandalay National Wildlife Refuge.

Despite his heavy workload in Baton Rouge, his primary residence is, and will remain, the city of Houma in Terrebonne Parish.



9:25 – 9:55am

James Carville, Opening Keynote

James Carville is America’s best-known political consultant. His long list of electoral successes evidences a knack for steering overlooked campaigns to unexpected landslide victories and for re-making political underdogs into upset winners.

His most prominent victory was in 1992 when he helped William Jefferson Clinton win the Presidency. In recent years, Carville has not been a paid political consultant for any domestic politicians or candidates for office, instead focusing on campaigns in more than 20 countries around the globe.

Carville is has also authored or co-authored 8-New York Times best sellers a best-selling author.

His most recent book with pollster and friend Stan Greenberg *It’s The Middle Class Stupid!* was released in 2012.

Most recently, Carville is a frequent political commentator and contributor on *This Week with George Stephanopoulos*. He also serves as a Professor of Practice at Tulane University in New Orleans, where he now resides.

Tuesday Lunch Panel Discussion

12:00 – 1:30 Great Hall Dining Area

This discussion will provide an update on the recent progress of the Louisiana Coastal Protection and Restoration Authority. The audience will gain insight into the growth and direction the coastal program through a retrospective overview of recent accomplishments, summary of current activities, and details of upcoming projects and initiatives

Kyle Graham

Executive Director, CPRA

Kyle Graham is the Executive Director for Louisiana’s Coastal Protection and Restoration Authority with responsibility for establishing policies, programs, and projects consistent with the state’s goals of a sustainable coastal area. Prior to joining the State of Louisiana, Kyle worked as a wetland scientist, restoring streams and wetlands, permitting impacts and preparing environmental documentation. He holds a BS in Biology from the University of North Carolina and a MS in Biology from Appalachian State University.

Wednesday Lunch Panel Discussion

12:00 – 1:30 Great Hall Dining Area

The Role of the Oil & Gas Industry as Stakeholder in Coastal Restoration

This panel will examine the continuing role of the Oil & Gas industry as a stakeholder in coastal restoration. Recognizing that the industry has a wealth of assets embedded in the coast, including not only pipelines, plants, refineries, wells, etc., but also the coastal employees who operate and maintain these assets, what vulnerabilities most concern the industry? How do they plan on adapting to the changing coastline? How does it wish to be engaged? What resources does it bring to the table to address large-scale restoration, coastal protection, and community resilience?

Thursday Lunch Panel Discussion

12:00 – 1:30 Great Hall Dining Area

Emerging Industries of Coastal Restoration and Protection

Moderated by Michael Hecht, GNO Inc.

As the economic development agency for the 10-parish greater New Orleans region, GNO, Inc. seeks to create proactive approaches towards job creation in innovative sectors. Given the vast experience and expertise regional firms have developed from years of Hurricane recovery, coupled with the significant investments in coastal restoration as a result of the 2010 Oil Spill and CPRA Master Plan, now is the time to build our Emerging Environmental industries and position the region as a hub of international resilience expertise. This lunch session will highlight the work GNO, Inc. is engaging in to cultivate diverse business leadership championing coastal restoration efforts, as well as its efforts in workforce development and business outreach to ensure the full economic impact of coastal restoration is realized.

Michael Hecht

President & CEO

Greater New Orleans, Inc.,



GNO, Inc.'s mission falls broadly into two categories: business development - attracting and growing businesses - and product development - creating better business conditions. Under Michael's leadership, GNO, Inc. was recently named the #2 economic development organization in the United States by Business Facilities magazine.

Before Coming to GNO, Inc. Michael led the quarter-billion dollar Katrina Small Business Recovery Program for the State of Louisiana. While with the State, Michael also established the \$90 million Louisiana Revolving Loan Fund, the first of its kind in the nation. In the years following 9/11, Michael worked for Mayor Michael Bloomberg in New York City as an Assistant Commissioner. Michael also served as inaugural Director of Business Development for the Food Bank for New York City, the largest in the country.

Michael's entrepreneurial experience includes co-founding a conglomerate of restaurant ventures, including "Foreign Cinema," named Restaurant of the Year 2000 in San Francisco. He began his career as a strategic management consultant.

Michael holds an MBA from Stanford Graduate School of Business, where he was a member of the Public Management Program, and an undergraduate degree from Yale University, magna cum laude.

Recently Michael has been recognized as "One of the 25 Most Powerful People in the 10/12 corridor," a New Orleans "Innovator of the Year," and one of "Ten People Who Made a Difference" in the South.

With family roots in Louisiana back to the 1830's, Michael now lives in New Orleans with his wife, Marlene, an ESL professor at Delgado, and his two sons, Dexter and Kaj ("Ki").



SOLUTIONS FOR SURVIVAL

In coastal Louisiana, rapid wetland loss and the increased frequency of flooding threaten the existence of our coastal communities and culture. As industry leaders, T. Baker Smith provides our clients with solutions that balance the need for coastal restoration and flood protection. This critical synergy is our "Solution for Survival."

Flood Protection:

- Flood Gates / Structures
- Levees
- Pump Stations
- Forced Drainage Systems

Restoration:

- Marsh Creation
- Beach Nourishment
- Freshwater Reintroduction
- Marsh Terracing
- Shoreline Protection



T. BAKER SMITH
SOLUTIONS START HERE

866.357.1050    tbsmith.com

PLANNING | ENVIRONMENTAL | SURVEYING | ENGINEERING | CONSTRUCTION | GIS / MAPPING



With local insights and commitment to the people and places we serve, Stantec connects to projects on a personal level.

Design with community in mind
stantec.com

Sound Science. Creative Solutions.®

SWCA
ENVIRONMENTAL CONSULTANTS



- NEPA Services
- Environmental Planning
- Environmental Regulatory Compliance
- Natural and Cultural Resource Management

For More Information: 225.663.3830 | www.swca.com



Flood Protection Hydraulic Structures
 Coastal Protection Coastal Restoration
 Hurricane Protection Program Management
 Permits and Regulatory Construction Management



BKI
BURK-KLEINPETER, INC.
 ENGINEERS, ARCHITECTS, PLANNERS, ENVIRONMENTAL SCIENTISTS
 NEW ORLEANS • BATON ROUGE • SHREVEPORT • JACKSON
 OCEAN SPRINGS • MOBILE • TUSCALOOSA • BIRMINGHAM
WWW.BKIUSA.COM



COASTAL ENVIRONMENTS, INC.

Full-service delivery locally and globally

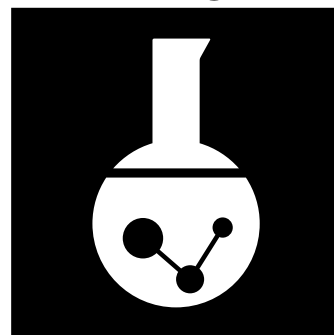

essential ingredients®

Engineers | Scientists | Consultants | Constructors
BrownandCaldwell.com

TUESDAY, MARCH 18, 2014

7:00 am – 9:00 am	Registration (Entrance Hall)
9:00 am – 10:00 am	Welcome Address & Opening Keynote Jerome Zeringue, Executive Assistant to the Governor for Coastal Activities James Carville, Political Consultant
10:00 am – 10:30 am	Morning Break with Refreshments (Exhibit Hall)
10:30 am – 12:00 pm	Session Block I Building Resiliency Workshop I (Panel Discussion) (Room 203-204) Moderator: Kali Rapp, Tulane University Panelists: Susan Cutter, University of South Carolina, Margaret Davidson, NOAA, Fikret Berkes, University of Manitoba, Hong Yuan Lee, Minister of the Interior, Taiwan CRMS Workshop (Room 205) Sarai Piazza, USGS, Marc Comeaux, USGS, Leigh Anne Sharp, CPRA Subsidence and Sea Level Rise I (Room 206) Moderator: Dalston Brunton 10:35 am – 11:00 am Stable Isotope and Nutrient Analysis to Determine Sediment Sources in the Rio Cruces Mike Risk, McMaster University 11:00 am – 11:25 am Sediment Coring and Post-Earthquake Recovery Estimates in the Rio Cruces Estuary Eduard Reinhardt, McMaster University 11:25 am – 11:50 am Evaluation of Global Climate Change, Hurricane Impacts, and Subsoil Subsidence on Louisiana's Dynamic Coastal Landscape Kimberly Landry, UNO, Student Presenter Coastal Law (Room 207) Moderator: 10:35 am – 11:00 am Benefit/Cost of Flood and Wind Mitigation Techniques for Residential Construction Fatima Orooji, LSU, Student Presenter 11:00 am – 11:25 am Develop of the CPRA Oyster Lease Acquisition and Compensation Program (OLACP) - From Litigation to Legislation Jason Shackelford, SWCA Consultants 11:25 am – 11:50 am Opportunities for Community Adaptation at the Local Level through Ordinances, Codes, and Design Patrick Michaels, LSU Matching Supply and Demand in River Diversions I (Room 208-209) Moderator: Ioannis Georgiou, UNO

- 10:35 am – 11:00 am Estimation of Sand Load in the Lower Mississippi River using a Dynamic 1-D Model
Alex McCorquodale, UNO
- 11:00 am – 11:25 am Building Land in a Delta from River-Sediment Diversions: Constraints, Potential, and Examples in the Mississippi River Delta
Sam Bentley, LSU
- 11:25 am – 11:50 am Sedimentary Dynamics of the Lower Mississippi River and Implications for River Diversions
Michael Ramirez, Tulane University, Student Presenter

Mangrove Restoration (Room 210)
Moderator: Michael Osland, USGS

- 10:35 am – 11:00 am Salt March Mangrove Structural Gradients: Implications for Restoration within a Shifting Ecotone in Louisiana and across the Northern Gulf of Mexico
Erik Yando, University of Louisiana at Lafayette, Student Presenter
- 11:00 am – 11:25 am Black Mangrove (*Avicennia germinans*) Restoration Ecology: Understanding Tolerance Limits to Guide Restoration
Mark Hester, University of Louisiana at Lafayette
- 11:25 am – 11:50 am Effect of Elevation and Soil Properties on Black Mangrove (*Avicennia germinans*) Survival and Growth in a Created Tidal Saline Wetland
Laura Hundy, University of Louisiana at Lafayette, Student Presenter

Hydrogeology (Room 211-212)
Moderator: Jennifer Mouton, CPRA

- 10:35 am – 11:00 am The Impact of Vertical Distortion on the Hydrodynamics and Sediment Transport in the Expanded Small-scale Physical Model
Clint Willson, The Water Institute of the Gulf
- 11:00 am – 11:25 am The Dynamics of Subterranean Flow in the Mississippi River Delta: How Waters below the Surface Impact our Coastal Landscape
Alexander Kolker, LUMCON
- 11:25 am – 11:50 am The Louisiana Freshwater Assessment Project: Science-based Decision Support for Water Resources in Louisiana
Bryan Piazza, TNC

A Louisiana Story (Room 201-202)
(78 minutes)

12:00 pm – 1:30 pm Lunch with Keynote Speaker, Kyle Graham, Executive Director, CPRA

1:30 pm – 3:00 pm Session Block II

Building Resiliency Workshop II (Panel Discussion) (Room 203-204)
Moderator: Elizabeth English, Buoyant Foundation Project
Panelists: Cynthia Sarthou, GRN, Jeffrey Thomas, Thomas Strategies, LTG Russel Honore, USACE retired, Patty Whitney, BISCO

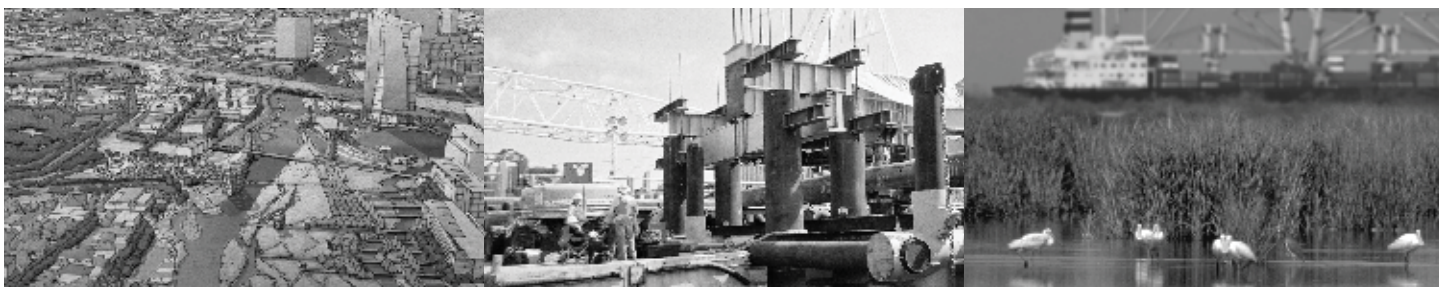

SOLVING MORE EFFECTIVELY

FOR MORE INFORMATION

Michael Ellis
Gulf Coast District
Water Manager
225.663.4310

Photos (left to right)
River of Life, Kuala Lumpur, Malaysia
Lake Borgne Surge Barrier, Louisiana, USA
Beneficial Reuse of Dredge Material, Texas, USA

We are AECOM. A full service global engineering firm with local offices in New Orleans, Baton Rouge, and throughout the Gulf Coast region. As a leader in professional, technical and management support services for natural and built environments, AECOM supports comprehensive solutions that protect, restore and conserve coastal ecosystems, while safeguarding coastal communities, preserving cultural resources, and balancing the often competing needs of transportation, navigation, oil and gas development, and land use planning.

AECOM...creating, enhancing and sustaining the world's built, natural and social environments.

www.aecom.com

AECOM

MAKING A DIFFERENCE FOR THE FUTURE OF OUR COAST

Visit us at Booth 77 to learn about how CSRS is making a difference for the future through the conservation, protection and preservation of our coastal areas.

CSRS
IMAGINE SHAPE DELIVER
WWW.CSRSONLINE.COM

Deltares USA

Dare to share

Deltares is an independent institute for applied research in the field of water, subsurface and infrastructure. Throughout the world, we work on smart solutions, innovations and applications for people, environment and society. Our main focus is on deltas, coastal regions and river basins. We believe in openness and transparency, as is evident from the free availability of a selection of our software and models.

<http://oss.deltares.nl>

www.deltares.org



PROTECTING THE
PLANET
IS EVERYONE'S
JOB.

WE AGREE.

Chevron is a proud supporter of the 2014 State of the Coast conference

The places we work are also the places we live. So we're committed to preserving the environment wherever we operate. We continually work to conserve natural resources and limit our environmental impact. Protecting the environment is always at the forefront of our minds. Because it only makes sense to take care of our home.

Learn more at chevron.com



Human Energy®

CHEVRON, the CHEVRON Hallmark and HUMAN ENERGY are registered trademarks of Chevron Intellectual Property LLC. © 2013 Chevron U.S.A. Inc. All rights reserved.

CRMS Workshop (Room 205)
Sarai Piazza, USGS, Marc Comeaux, USGS, Leigh Anne Sharp, CPRA

Subsidence and Sea Level Rise II (Room 206)
Moderator: Patricia Strayer, Battelle

- | | |
|-------------------|--|
| 1:35 pm – 2:00 pm | Modeling Basement Subsidence Beneath and Beyond the Mississippi Delta
Torbjörn Törnqvist, Tulane University |
| 2:00 pm – 2:25 pm | Comparative Influence of Chronic Sea Level Rise vs. Acute Hurricane Disturbance on Coastal Bottomland Hardwood Swamp Productivity: Lessons for Living on the Edge?
Julie Whitbeck, Jean Lafitte National Park |
| 2:25 pm – 2:50 pm | Beyond just Sea Level Rise: Incorporating Climate into Coastal Wetland Vulnerability Assessments
Michael Osland, USGS |

Communicating Flood Risk (Room 207)
Moderator: Nina Reins, MWH

- | | |
|-------------------|--|
| 1:35 pm – 2:00 pm | Economically Efficient Flood Protection Standards for The Netherlands
Jarl Kind, Deltares |
| 2:00 pm – 2:25 pm | Assessment of Present and Future Safety Level of Dikes and Levees
Meindert Van, Deltares |
| 2:25 pm – 2:50 pm | A New National Weather Service Storm Surge Warning and Inundation Graphic
Jamie Rhome, NOAA-NHS |

Matching Supply and Demand in River Diversions II (Room 208-209)
Moderator: Alexander Kolker, LUMCON

- | | |
|-------------------|--|
| 1:35 pm – 2:00 pm | Effects of Freshwater Inflow on Fish and Shrimp in the Receiving Basin of a River Diversion
Kim de Mutsert, George Mason University |
| 2:00 pm – 2:25 pm | Lower Mississippi River Sediment Diversions Cumulative Benefit/ Impact Screening Tool
Stokka Brown, Moffatt & Nichol |
| 2:25 pm – 2:50 pm | A Comparative Study of Nitrogen Cycling in the Caernarvon Diversion, Bonnet Carre Spillway and Wax Lake Delta
John White, LSU |

Vegetative Response to Hydrologic Change (Room 210)
Moderator: Jenneke Visser, University of Louisiana at Lafayette

- | | |
|-------------------|---|
| 1:35 pm – 2:00 pm | Limitations of Hydrologic Regime on Schoenoplectus spp. Survival and Establishment: Implications for Marsh Restoration
Taylor Sloey, University of Louisiana at Lafayette, Student Presenter |
|-------------------|---|

- 2:00 pm – 2:25 pm Effects of Hydroperiod Variation on Vegetation Belowground Productivity: Implications for River Diversions
Gregg Snedden, USGS
- 2:25 pm – 2:50 pm Controls on Resistance of Sediment-Amended Salt Marshes to Climate Change-Induced Disturbances
Camille Stagg, USGS

Greater New Orleans Urban Water Plan (Room 211-212)
Moderator: Robin Barnes, GNO Inc.

- 1:35 pm – 2:00 pm Innovative Stormwater Management Strategies to Create a Sustainable Region
David Waggonner, Waggonner and Ball Architects
- 2:00 pm – 2:25 pm Changing the Paradigm: Stormwater Management for the Greater New Orleans Area
Jessica Watts, CDM Smith
- 2:25 pm – 2:50 pm Louisiana's 2012 Coastal Master Plan, the City of New Orleans' Master Plan, and the Greater New Orleans Urban Water Plan: Integrated Flood Protection and Building Resilient Communities
Mark Davis, Tulane University

A Louisiana Story (Room 201-202)
(78 minutes)

3:00 pm – 3:30 pm Afternoon Break with Refreshments (Exhibit Hall)

3:30 pm – 5:00 pm Session Block III

Local Economic Resilience (Room 203-204)
Moderator: Stephanie Powell, NWF

- 3:35 pm – 4:00 pm Backyard Gardens and After-School Crabbing: The Importance of Subsistence in Community and Culture in Coastal Louisiana
Shana Walton, NSU
- 4:00 pm – 4:25 pm Where Will Boaters Dock? Information to Increase Post-Storm Resilience of the Commercial Fishing Sector in Vermilion Bay
Lauren Land, Louisiana SeaGrant
- 4:25 pm – 4:50 pm Title Forthcoming
Author Forthcoming

WIFI Room (Room 205)

Private and Public Adaptations to a Changing Climate (Panel Discussion) (Room 206)
Moderator: Torbjörn Törnqvist, Tulane University
Panelists: Virginia Burkett, USGS, Robin Barnes, GNO, Inc., Cynthia McHale, Ceres, and Karim Belhadjali, CPRA



IHNC Hurricane Surge Barrier
New Orleans, LA

PROTECTING the coast of Louisiana

- Prevented an estimated \$5 Billion in damage from Hurricane Isaac
- Award Winning Design and Results:
 - 2011 ENR Best Civil Works/Infrastructure Project
 - ACEC's 2012 Grand Conceptor



Ben C. Gerwick, Inc. | COWI

marine foundations & structures



**PROVIDING COASTAL ENGINEERING & MANAGEMENT
SOLUTIONS FOR SUSTAINABLE COASTS**



- | | | |
|------------------------|------------------------|-----------------------|
| - Shoreline Protection | - Breakwaters | - Port Infrastructure |
| - Marsh Creation | - Shoreline Monitoring | - Port Navigation |
| - Habitat Restoration | - Wetlands Studies | - Port Economic Dev. |

KENNER, LA WAVELAND, MS HOUSTON, TX BATON ROUGE, LA
www.deii.net

DUCKS UNLIMITED
LEADER IN WETLANDS CONSERVATION

**DELIVERING A
SUSTAINABLE COAST**



**DUCKS
UNLIMITED**



Bringing Innovative Solutions to Louisiana's Coastal Challenges for Over 27 Years

Louisiana Offices
Baton Rouge | 225-381-8454
New Orleans | 504-832-9502

The CH2M HILL Vision:

- **Integrate.** Combine global knowledge and local expertise to address the issues of our complex and dynamic coast
- **Restore.** Rebuild a sustainable coast for Louisiana
- **Monitor.** Dynamic system-wide monitoring to evaluate project effectiveness and ecosystem changes
- **Protect.** Sustain healthy ecosystems and promote resilient communities in partnership with local, state, and federal stakeholders

Around the world and close to home, CH2M HILL employees provide the full spectrum of consulting, design, design-build, operations, and program management services to restore and protect our nation's coasts.

CH2MHILL.com

© 2014 CH2M HILL
ES013114062116MKE

FTN Associates, Ltd.

- 30+ Yrs Experience in Coastal LA
- Hydrologic, Hydraulic, CFD & Water Quality Modeling
- Master Stormwater Plans
- Flood Protection Studies
- FEMA FIS & Related Analyses
- CWPPRA & CIAP Studies
- Wave & Shoreline Protection Analyses
- Sediment Transport



See us in Booth #50

(225) 766-0586
www.ftn-assoc.com

water resources / environmental consultants

Baton Rouge, LA
Little Rock, AR Fayetteville, AR Jackson, MS



Nearly 50 Years

GeoEngineers, Inc. is nearing its 50th year of geotechnical engineering experience on coastal projects related to restoration and the needs of industry and infrastructure. With in-house exploration capabilities and a USACE, AASHTO and ASTM certified lab, we offer coastal geotechnical engineering services from start to finish, and we've been doing it for decades.

Stop by **Exhibit Booth #7** to learn more or contact David Eley, PE or Charlie Eustis, PE, Principals in our Baton Rouge office.

GEOENGINEERS
BATON ROUGE, LOUISIANA

225.293.2460
deley@geoengineers.com
ceustis@geoengineers.com

www.geoengineers.com

SILVER
SPONSOR

National Flood Insurance Program (Room 207) Moderator: Taylor Marshall, The Water Institute

- 3:35 pm – 4:00 pm The NFIP Program: Program Overview and Fallout from the 2012 Reform Act
Patricia Skinner, LSU AgCenter
- 4:00 pm – 4:25 pm Building a Coalition for Sustainable Flood Insurance
Michael Hecht, GNO, Inc.
- 4:25 pm – 4:50 pm Addressing Concerns of BW-12 through the Community Rating System (CRS)
Monica Teets Farris, UNO

Planning for Large River Diversions I (Room 208-209) Moderator: Wes Leblanc, CPRA

- 3:35 pm – 4:00 pm Innovative Approach to Future Conditions Basin-Side Modeling for Diversion Projects: LCA Medium Diversion at Myrtle Grove with Dedicated Dredging Project
Mark Hammons, FTN Associates
- 4:00 pm – 4:25 pm Feasibility Studies for Large-Scale Mississippi River Sediment Diversions
Jenni Schindler, C. H. Fenstermaker
- 4:25 pm – 4:50 pm Hydrodynamic and Sediment Transport Modeling using FLOW-3D for Siting and Optimization of the LCA Medium Diversion at White Ditch
Hugh Roberts, Arcadis

Vegetation Changed: Past, Present, and Future (Room 210) Moderator: Jenneke Visser, University of Louisiana at Lafayette

- 3:35 pm – 4:00 pm Redefining Salinity Regimes for Wetland Vegetation along the Louisiana Coast
Whitney Broussard, University of Louisiana at Lafayette
- 4:00 pm – 4:25 pm Changes in Distribution of Common Plant Species in Coastal Louisiana: 1997-2013
Jenneke Visser, University of Louisiana at Lafayette
- 4:25 pm – 4:50 pm Modeling Louisiana's Coast Plant Communities
Scott Duke-Sylvester, University of Louisiana at Lafayette

Watersheds and Water Quality (Room 211-212) Moderator: Marisa Escudero, Land Trust for Louisiana

- 3:35 pm – 4:00 pm Water Quality of Lake Pontchartrain during Bonnet Carré Spillway Diversion and Non-Diversion Years
Scott Mize, USGS
- 4:00 pm – 4:25 pm Decadal Trends in Nutrient Input from Four Major Rivers in Southwest Louisiana to the Gulf of Mexico
Songjie He, LSU, Student Presenter
- 4:25 pm – 4:50 pm Total Organic Carbon Loading from Louisiana's Four Major Coastal Watersheds to the Gulf of Mexico
Songjie He, LSU, Student Presenter

A Louisiana Story (Room 201-202)
(78 minutes)

5:00 pm - 7:00 pm Opening Reception (Exhibit Hall)

WEDNESDAY, MARCH 19, 2014

7:00 am – 8:30 am Registration (Entrance Hall)

8:30 am – 10:00 am Session Block IV

Citizen Participation in Coastal Restoration Moderator: (Room 203-204)
Moderator: Derek Brockbank, Mississippi River Delta Campaign

8:35 am – 9:00 am Citizen-led Monitoring of Barataria Basin Impacts and Restoration
Scott Eustis, Gulf Restoration Network

9:00 am – 9:25 am Citizen Science Group Provides in situ Data and Enhanced
Experiences for NASA DEVELOP Interns
Ross Reahard, UNO, Student Presenter

9:25 am – 9:50 am Barataria Lafitte Stakeholder Engagement Process
Corey Miller, Coalition to Restore Coastal Louisiana

WIFI Room (Room 205)

Fisheries (Room 206)
Moderator: Patricia Strayer, Battelle

8:35 am – 9:00 am Development and Adaptation of the CASM to Evaluate Food Web
Dynamics and Species Responses in Barataria Basin
Shaye Sable, Dynamic Solutions

9:00 am – 9:25 am Title Forthcoming
Author Forthcoming

9:25 am – 9:50 am Larval Crab Distribution in the Gulf of Mexico
Sarah Giltz, Tulane University, Student Presenter

Oil Spill: Droplets to Landscape (Room 207)
Moderator: Jenneke Visser, ULL

8:35 am – 9:00 am Putting the Canary Back in the Coal Mine: Crickets and Ants in the
Saltmarshes Post Macondo Blowout
Linda Hooper-Bui, LSU

9:00 am – 9:25 am Dispersant Effect in Enhancing the Droplet and Particle Formation
by Bursting Bubbles
Paria Avij, LSU, Student Presenter

9:25 am – 9:50 am Extent and Degree of Shoreline Oiling in Louisiana 2010-2013:
Deepwater Horizon Oil Spill
Scott Zengel, Atkins

Coastal Wetlands Restoration on Private Lands



United States
Department of
Agriculture

Natural Resources Conservation Service

USDA is an equal opportunity provider and employer.

www.la.nrcs.usda.gov

HDR

WATER & NATURAL RESOURCES
www.hdrinc.com



Building Resilient Coastlines

HDR offers integrated and comprehensive coastal engineering services, from designing effective breakwaters, marsh creation and beach nourishment to development of navigation channels. We have the expertise to meet the challenges presented in creating sustainable coastal projects to protect and restore habitats from the impacts of wind, waves, and weather.



Audubon
LOUISIANA

"Where birds thrive, people prosper"

Audubon is a proud sponsor of the
2014 State of the Coast Conference
and partner of the
Mississippi River Delta Restoration Campaign.



**Committed to delivering coastal water resources
expertise that strengthens communities and positively
impacts the quality of life**

ARCHITECTS ENGINEERS CONSULTANTS

www.dewberry.com

 **Dewberry®**

 **NEEL-SCHAFER**
Solutions you can build upon

Neel-Schaffer offers our coastal communities water resources and civil works flood damage reduction solutions. We provide a full range of civil, structural, hydraulic, hydrological, geotechnical, environmental, sanitary, electrical, mechanical, surveying, mapping and CADD services.



Doug Burgin

225-924-0235

www.neel-schaffer.com



**WE'RE COMMITTED TO
SAFETY AND PROSPERITY
IN OUR COMMUNITIES.**

At Phillips 66, protecting and supporting our people, our environment and our communities guides everything we do, and it always will. That's why Alliance Refinery is a proud sponsor of THE STATE OF THE COAST CONFERENCE brought to you by the Coalition to Restore Coastal Louisiana.

www.Phillips66.com

© Phillips 66 Company. 2014. All rights reserved.

Planning for Large River Diversions II (Room 208-209)

Moderator: Susan Testroet-Bergeron, USGS

- | | |
|-------------------|--|
| 8:35 am – 9:00 am | A Quantitative Comparison of Modeling Approaches for Simulating Land Building Processes from River and Sediment Diversions
Clinton Willson, The Water Institute of the Gulf |
| 9:00 am – 9:25 am | USACE Status of Evaluating and Permitting Lower Mississippi River Diversions
Mark Wingate, USACE |
| 9:25 am – 9:50 am | Development of Models and Tools for Planning for Sediment Diversions in a Systems Context
Angelina Freeman, CPRA |

Faunal Ecology and a Changing Environment Moderator (Room 210)

Moderator: Paul Leberg, University of Louisiana at Lafayette

- | | |
|-------------------|---|
| 8:35 am – 9:00 am | Potential Impacts of Sea-Level Rise on the Migration Ecology of Shorebirds on the Northern Gulf of Mexico
Jessica Henkel, Tulane University, Student Presenter |
| 9:00 am – 9:25 am | Predicting the Impacts of River Diversion and Sea-level Rise on Eastern Oyster Growth and Production
Hongqing Wang, USGS |
| 9:25 am – 9:50 am | Marsh Management and Bird Responses in southern Vermilion Parish, LA
Erik Johnson, National Audubon Society |

Deltaic Biogeochemistry (Room 211-212)

Moderator: Estelle Robichaux, EDF

- | | |
|-------------------|---|
| 8:35 am – 9:00 am | Nutrient Biogeochemistry during the Early Stages of Development in the Mississippi River Deltaic Floodplain
Robert Twilley, Louisiana SeaGrant |
| 9:00 am – 9:25 am | Practical Examples of Integrated Ecosystem Modeling - When Water, Sediment, Vegetation, Climate and Man Meet
Luca Sittoni, Deltares |
| 9:25 am – 9:50 am | Modeling Primary Production in a Turbid Estuary
Bas Maren, Deltares |

My Louisiana Love (Room 201-202)

(64 minutes)

10:00 am– 10:30 am Morning Break with Refreshments (Exhibit Hall)

10:30 am – 12:00 pm Session Block V

Community Resilience (Room 203-204)

Moderator: Natalie Peyronnin, Environmental Defense Fund

- 10:35 am – 11:00 am Sharing Perspectives on Social Science: Best Practices for Gulf Coast Restoration
Jeffrey Buchanan, The Nature Conservancy
- 11:00 am – 11:25 am CPRA Coastal Community Resiliency Program
Melanie Saucier, CPRA
- 11:25 am – 11:50 am Assessing the Potential for Cost-Effective Nonstructural Risk Reduction in Coastal Louisiana
David Johnson, RAND Corporation

TNC Decision Support Tool Workshop (Room 205)
Nicole Love, TNC, Lauren Land, Louisiana SeaGrant, Bryan Piazza, TNC

Blue Carbon (Panel Discussion) (Room 206)
Moderator: Robert Twilley, Louisiana SeaGrant
Panelists: Sarah Mack, Tierra Resources, Steven Emmott Mattox, RAE, Bryan Perez, CH2M Hill

Oil and Gas Impacts (Room 207)
Moderator: Aaron Bass, CH2M Hill

- 10:35 am – 11:00 am Community Resilience and Oil Spills in Coastal Louisiana
Craig Colten, The Water Institute of the Gulf
- 11:00 am – 11:25 am Historical Dynamics of the Pipeline Canal and Land Loss Controversy
Jason Theriot
- 11:25 am – 11:50 am Regression Analysis Supports Using Models to Determine NRDA Claims for Small Coastal Oil Spills
Dwight Dunk, CDM Smith

Permitting (Panel Discussion) (Room 208-209)
Moderator: Tony Risko, URS
Panelists: Mike Turner, USACE, Bren Haase, CPRA, Martin Maher, USACE

Barrier Island Ecology and Restoration (Room 210)
Moderator: Mark Hester, University of Louisiana at Lafayette

- 10:35 am – 11:00 am Pelican Reproductive Ecology on Barrier Islands: Considerations for Restoration
Paul Leberg, University of Louisiana at Lafayette
- 11:00 am – 11:25 am Influence of Barrier Island Loss on the Distribution and Survival of Brown Pelicans in Coastal Louisiana
Kristin Wakeland, University of Louisiana at Lafayette, Student Presenter
- 11:25 am – 11:50 am Evaluation of Louisiana Barrier Shoreline Restoration Strategies and its Applicability in Damage Assessment
Michael Poff, Coastal Environment Consultants

Geochemical Response (Room 211-212)
Moderator:

- 10:35 am – 11:00 am A Fluorometer-Based Method for Determination of Biochemical Oxygen Demand
Zhen Xu, LSU AgCenter, Student Presenter

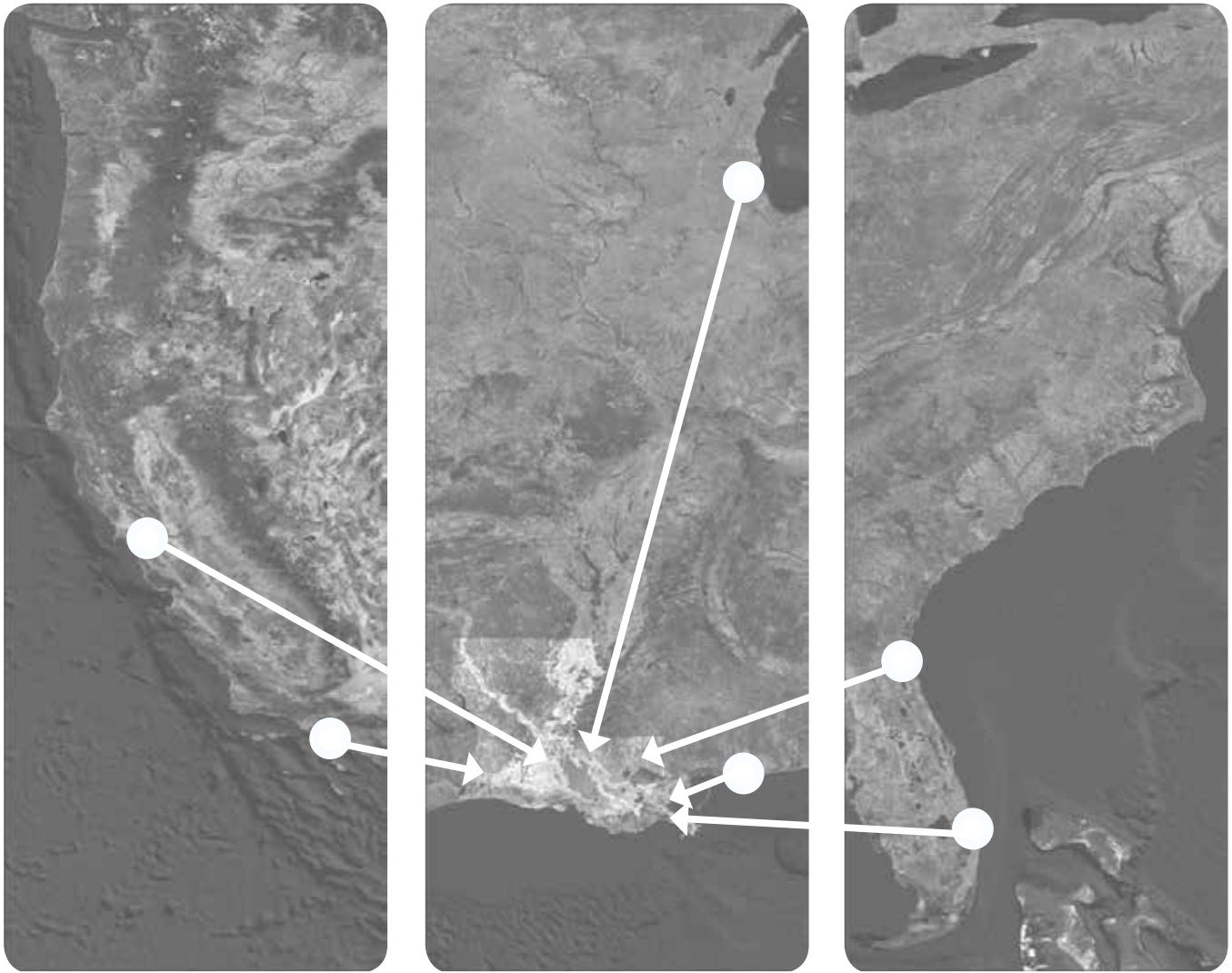

EXPERIENCE GAINED.

KNOWLEDGE SHARED.

*Using coastal science, engineering, and planning experience from
four coasts to provide solutions for Louisiana*

1.800.883.5588
www.hecinc.com



Louisiana-owned
since 1986

“Unless someone like you
cares a whole awful lot,
nothing is going to get
better. It's not.”

Dr. Seuss (1904–1991), *The Lorax*



536 Washington Avenue, New Orleans, Louisiana 70130
P: 504.962.5360 F: 504.962.5362
www.gaeaconsultants.com

Coastal Engineering

Hydraulic and Hydrologic Modeling

Civil Engineering

Environmental Consulting and Engineering

Cultural Resources



ROYAL ENGINEERS & CONSULTANTS
ENGINEERING POSSIBILITIES

SOUTHERN EARTH SCIENCES, INC.

ENVIRONMENTAL, GEOTECHNICAL, SUBSURFACE INVESTIGATIONS
& CONSTRUCTION MATERIALS TESTING



*Southern Earth Sciences, Inc. has been providing
quality, value and innovative solutions since 1976.*

*We are a full-service engineering firm providing
Geotechnical, Subsurface Investigations,
Environmental and Construction Materials Testing services.*

*Visit us at www.soeearth.com
to see how we can partner on your next project.*

- | | |
|---------------------|--|
| 11:00 am – 11:25 am | The Human-Mediated Flow of Phosphorus in Louisiana's Dynamic Coastal Landscape
Eric Roy, LSU, Student Presenter |
| 11:25 am – 11:50 am | Long-Term Dynamics of Dissolved Oxygen in a Coastal Plain Shallow Lake
Zhen Xu, LSU AgCenter, Student Presenter |

My Louisiana Love (Room 201-202)
(64 minutes)

1:30 pm – 3:00 pm Session Block VI

Creating Resilient Coastal Communities (Room 203-204)
Moderator: Craig Colten, The Water Institute of the Gulf

- | | |
|-------------------|--|
| 1:35 pm – 2:00 pm | Strategies for Building Community Resiliency
Jeffrey Carney, LSU |
| 2:00 pm – 2:25 pm | Building Resilience Community by Community
Pam Jenkins, UNO |
| 2:25 pm – 2:50 pm | Influences on Community Resilience: An Examination of Population Return to New Orleans Post-Katrina
Margaret Reams, LSU |

TNC Decision Support Tool Workshop (Room 205)
Nicole Love, TNC, Lauren Land, Louisiana SeaGrant, Bryan Piazza, TNC

Barrier Shoreline Restoration (Room 206)
Moderator: Brad Miller, CPRA

- | | |
|-------------------|--|
| 1:35 pm – 2:00 pm | Caminada Headland Beach and Dune Restoration, the First Use of Ship Shoal Sand for Restoration
Brad Miller, CPRA |
| 2:00 pm – 2:25 pm | Cameron Parish Shoreline Restoration
Bill Feazel, CPRA |
| 2:25 pm – 2:50 pm | Compactional Subsidence and Barrier Island Restoration: Caminada-Moreau Headland Subsidence Study
Mark Byrnes, Applied Coastal Research & Engineering |

Social Effects of Deepwater Horizon (Room 207)
Moderator: Brian Marks, LSU

- | | |
|-------------------|--|
| 1:35 pm – 2:00 pm | Variability in the Socioeconomic Effects of the BP Oil Spill: Ethnographic Findings from Gulf Coast Communities by Place and Economic Sector
Brian Marks, LSU |
| 2:00 pm – 2:25 pm | Living Amid Uncertainty: Social Effects of the Deepwater Horizon Disaster
Monique Verdin |
| 2:25 pm – 2:50 pm | Finding Patterns and Drawing Conclusions: The Challenges of |

Measuring Social Effects
Diane Austin, University of Arizona

Diversions: Basin-Side (Room 208-209)
Moderator: Denise Reed, The Water Institute of the Gulf

- | | |
|-------------------|--|
| 1:35 pm – 2:00 pm | Morphodynamic Assessment of Sediment Diversions
Ehab Meselhe, The Water Institute of the Gulf |
| 2:00 pm – 2:25 pm | Consolidation and Suspension Properties of Mud from Lake Lery and Relevance to Wetland Restoration
Edward Lo, LSU, Student Presenter |
| 2:25 pm – 2:50 pm | Tree Production and Growth in Tidal Swamps and the Operation of the Davis Pond Diversion during the Deepwater Horizon Incident
Beth Middleton, USGS |

Living Shorelines (Room 210)
Moderator: Jesse Noel, Stanley Consultants, Inc.

- | | |
|-------------------|---|
| 1:35 pm – 2:00 pm | Evaluating the Shoreline Protection Functioning of Three Divergent Constructed Oyster Reef Structures in Terrebonne Bay, Louisiana
Glen Curole, CPRA |
| 2:00 pm – 2:25 pm | Establishing Design Criteria: Living Shorelines
Matt Campbell, Coastal Harbor & Engineering |
| 2:25 pm – 2:50 pm | Living Shoreline Demonstration Project-Analysis of Concept Performance
Josh Carter, Coastal Harbor & Engineering |

Planning Large Hydrological Restorations (Room 211-212)
Moderator: Wes Leblanc, CPRA

- | | |
|-------------------|--|
| 1:35 pm – 2:00 pm | Calcasieu Salinity Control Measures
Austin Feldbaum, CPRA |
| 2:00 pm – 2:25 pm | Houma Navigation Canal (HNC) Lock Complex
Kenneth Bahlinger, CPRA |
| 2:25 pm – 2:50 pm | Increase Atchafalaya Flow to Terrebonne
Austin Feldbaum, CPRA |

Water Like Stone (Room 201-202)
(87 minutes)

3:00 pm – 3:30 pm Afternoon Break with Refreshments (Exhibit Hall)

3:30 pm – 5:00 pm Session Block VII

The Master Plan's Dark Matter: the Non-Structural Program (Panel Discussion)
(Room 203-204)

Moderator: Craig Colten, The Water Institute of the Gulf

Panelists: Mike Blum, Tulane University, Scott Hemmerling, The Water Institute of the Gulf, Christopher Dalbom, Tulane University, Josh Lewis, Tulane University, and Mark Davis, Tulane University

Research

Outreach

Education

Law & Policy

Louisiana Sea Grant is pleased to sponsor the following graduate and undergraduate students attending State of the Coast 2014:

LSU

Ian Brown
Parichehr Saranjampour
Casey Pickell
Charmaine Borne
Paria Avij
Ling Zhu
Ke Liu
Linlin Cui
Songjie He
Fatemeh Orooji
Getnet Agegnehu
Kyle Parker
Agnimitro Chakrabarti

McNeese

Amit Sharma

Tulane

Elizabeth L. Chamberlain
Ciara Chambers
Sarah Giltz

ULL

Bobby Wells Soukanh
Kristin Wakeland
Jessica Schulz
Mirka Zapletal
Rifat Quamrul Alam
Nicholas McCoy
Selina Jahan Sumi
D. Stephen Nevitt II
Erik Yando
Madeleine Bodin
Scott F. Jones
Laura Hundy
Clair C. Coussan

UNO

Greg A. Mattson II

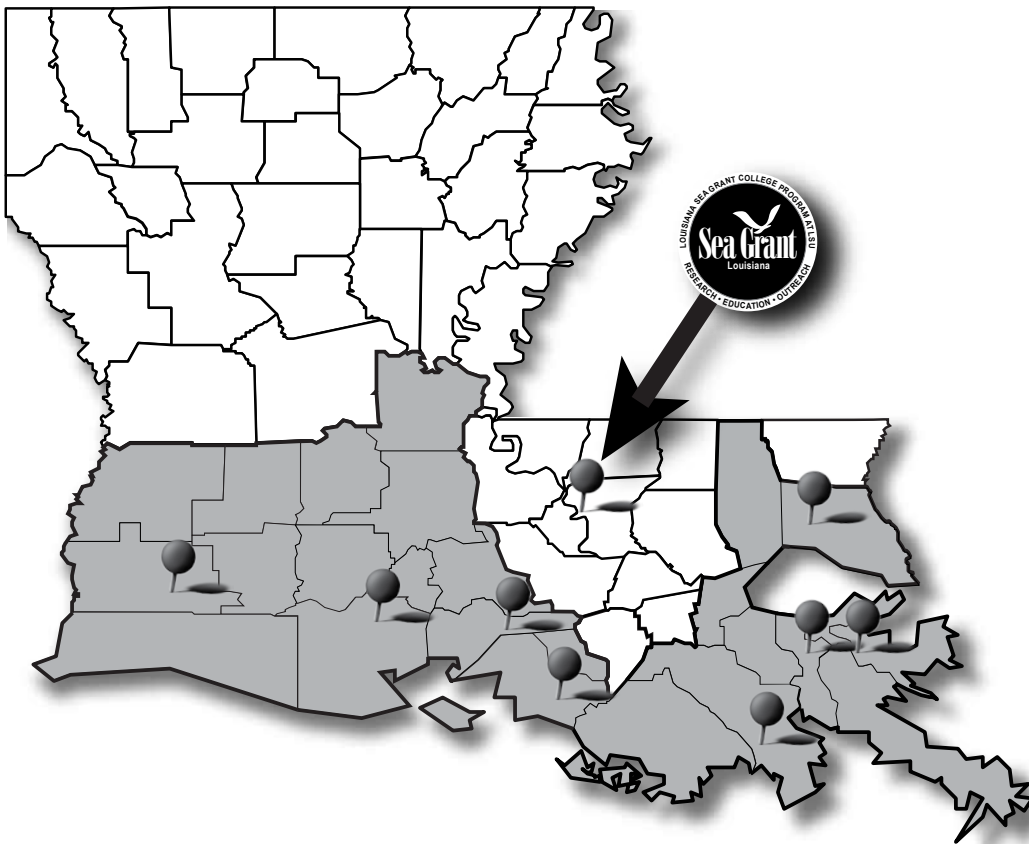

Louisiana Sea Grant College Program at LSU



Serving coastal Louisiana since 1968
www.laseagrant.org



*Providing exceptional design
services for over 35 years*



Lonnie G. Harper & Associates, Inc.
CIVIL ENGINEERING AND LAND SURVEYING CONSULTANTS



**Coastal Restoration and
Protection**



Surveying



**Structural and Foundation
Design**



**Transportation
Engineering**



**Coastal
Engineering**



Site Development

2746 Hwy 384
Bell City, Louisiana 70630
337.905.1079

www.harper-group.com



THE BEST DEFENSE IS A GOOD OFFENSE

no more loss of yards.

The Louisiana coast loses the equivalent of a football field every hour. With offices in New Orleans and Baton Rouge, Moffatt & Nichol sees the significance of this complex ecosystem every day and is committed to providing the best defense. Our planning, design, permitting, modeling and navigation expertise in coastal protection and restoration gives you a game plan you can trust.

Put the Moffatt & Nichol team to work for you.



moffatt & nichol

www.moffattnichol.com

WIFI Room (Room 205)

Borrow Site Morphology (Room 206)

Moderator: Rudy Simoneaux, CPRA

- | | |
|-------------------|---|
| 3:35 pm – 4:00 pm | Morphological Modeling of Mississippi River Sediment Borrow Sites
Santiago Alfageme, Moffatt & Nichol |
| 4:00 pm – 4:25 pm | Changes in Channel Bar Morphology and Sediment Infilling Rates in Response to Dredging within the Lower Mississippi River
Brendan Yuill, The Water Institute of the Gulf |
| 4:25 pm – 4:50 pm | Borrow Area Monitoring and Management (BAMM) Program for Coastal Restoration in Louisiana
Syed Khalil, CPRA |

Storm Surge Prediction and Impact (Room 207)

Moderator:

- | | |
|-------------------|---|
| 3:35 pm – 4:00 pm | Delft3D Modeling of Hurricane-Induced Surge and Waves in Coastal Louisiana
Kelin Hu, LSU |
| 4:00 pm – 4:25 pm | Surge Barrier Impact on Salinity in Vermilion Bay
Justin Shaw, C.H. Fenstermaker |
| 4:25 pm – 4:50 pm | Analysis of Storm Surge and Wave Reduction by Restoration Projects in Barataria Basin, Louisiana
Haihong Zhao, Arcadis |

LCA Mississippi River Hydrodynamic and Delta Management Study I (Room 208-209)

Moderator: Cherie Price, USACE

- | | |
|-------------------|--|
| 3:35 pm – 4:00 pm | Field Observations in Support of Modeling Salt Wedge Dynamics and Lateral Sand Bar Dynamics in the Lower Mississippi River in Louisiana
Mead Allison, The Water Institute of the Gulf |
| 4:00 pm – 4:25 pm | Field Data Collection Effort under the Mississippi Hydro Project
Thad Pratt, USACE |
| 4:25 pm – 4:50 pm | MRHDMS Data Delivery and Visualization on LCA.GOV
Craig Conzelmann, USGS |

Technological Innovations for Shoreline Protection (Room 210)

Moderator:

- | | |
|-------------------|--|
| 3:35 pm – 4:00 pm | Inventing Coastlines: The Patented Technologies of Artificial Marine Habitats and Coastal Infrastructure
Richard Hindle, LSU |
| 4:00 pm – 4:25 pm | Development of an Interactive Suspended Wave Screen as a Shoreline Protection Alternative to Rock with Applicability in Weak Soils
Josef Hoffman, Royal Engineering |
| 4:25 pm – 4:50 pm | Assessment of Oyster Reed Development on Fabricated Gabion |

Mats, A-Jacks and ReefBlks at CWPPRA Project TE-45, Terrebonne Bay, Four Years Post Construction
Earl Melancon, NSU

Restoration Management (Room 211-212)
Moderator: Lynette Cardoch, MWH Global

3:35 pm – 4:00 pm	Adaptive Management of the Central Terrebonne Marshes Marc Johnson, FTN Associates
4:00 pm – 4:25 pm	The Big Picture: An Analysis of Institutional Structures Estelle Robichaux, EDF
4:25 pm – 4:50 pm	Large-scale Coastal Restoration of Salt Marshes and Tidal Flat Ecosystems along the Arabia Gulf: Applying Principals of Adaptive Management Jacqueline Michel, Research Planning, Inc.

Water Like Stone (Room 201-202)
(87 minutes)

5:00 pm – 6:00 pm Happy Hour Poster Session (Entrance Hall)

THURSDAY, MARCH 20, 2014

8:30 am – 10:00 am Session Block VIII

Planning Tools for Community Resilience and Stormwater Management
(Room 203-204)
Moderator: Pam Jenkins, UNO

8:35 am – 9:00 am	Town of Jean Lafitte and Lafourche Parish Comprehensive Resiliency Plans Jeannette Dubinin, CPEX
9:00 am – 9:25 am	Planning and the Pursuit of Resilience in Post-Katrina Louisiana: An Examination of Parish-level Attitudes and Actions Betsy Paille, LSU
9:25 am – 9:50 am	Leveraging GIS Tools and Existing Data to Develop a Master Stormwater Plan for Lafourche Parish Marc Johnson, FTN

WIFI Room (Room 205)

Sediment Management: Borrow and Fill (Room 206)
Moderator: Rudy Simoneaux, CPRA

8:35 am – 9:00 am	Evaluation of Settling Velocity of Fine-Grained Dredged Sediments Used in Coastal Restoration Projects Gregory Mattson II, UNO, Student Presenter
9:00 am – 9:25 am	Shoaling Anaysis of the Calcasieu Ship Channel Loop Pass Mitch Andrus, Royal Engineering
9:25 am – 9:50 am	Utilizing Mississippi River Sediment as a Renewable Coastal



- geocomposites

- enkamat HPTRM

- structural geotextile tubes

- articulating concrete block mats

- lightweight aggregate bags

- marine mattresses



INDUSTRIAL FABRICS, INC.

800-848-4500



**PREMIER CONCRETE
PRODUCTS, INC.**

800-575-7293

Supporting Coastal Engineers Since 1981

ind-fab.com • shoretec.com • envirotubes.com

tensarcorp.com/Systems-and-Products/Triton-Systems/Triton-Marine-Mattress-System

Restoration Strategy
Paul Tschirky, Moffatt & Nichol

Wetlands and Waves I (Room 207)
Moderator: Tonja Koob, Gaea Consultants

- | | |
|-------------------|---|
| 8:35 am – 9:00 am | Numerical Modeling of Surface Waves over Submerged Flexible Vegetation
Ling Zhu, LSU, Student Presenter |
| 9:00 am – 9:25 am | Simulation of Storm-Surge Flood on Coastal Wetlands using the Immersed Boundary Method
Ning Zhang, McNeese University |
| 9:25 am – 9:50 am | Probability Distribution of Wave Heights Attenuated by Salt Marsh Vegetation during Tropical Cyclone
Ranjit Jadhav, FTN Associates |

LCA Mississippi River Hydrodynamic and Delta Management Study II
(Room 208-209)
Moderator: Barbara Kleiss, USACE

- | | |
|-------------------|---|
| 8:35 am – 9:00 am | Geomorphic Assessment of the Lower Mississippi River, Old River to Head of Passes
David Biedenbarn, Biedenbarn Group |
| 9:00 am – 9:25 am | Adaptive Hydraulics-SEDLIB Modeling of the Riverside Impacts of Sediment Diversions in the LMR
Gary Brown, USACE |
| 9:25 am – 9:50 am | One-dimensional Sedimentation Modeling of the Lower Mississippi River Response to Proposed Sediment Diversions
Ronald Heath, USACE |

Stakeholder Partnerships (Room 210)
Moderator: Nicole Love, TNC

- | | |
|-------------------|--|
| 8:35 am – 9:00 am | The Southwest Coastal LA Feasibility Study: A Reluctant Partnership
Norwyn Johnson, CPRA |
| 9:00 am – 9:25 am | EPA Urban Waters Program: Reconnecting Urban Communities to Their Waterways
Danny Wiegand, EPA |
| 9:25 am – 9:50 am | Louisiana's Water Innovation Cluster: Is It Ready for Global Competition?
Stephen Picou, Horizon Initiative Water Committee |

International Perspectives on Coastal Restoration (Room 211-212)
Moderator: Mel Landry III, NOAA

- | | |
|-------------------|--|
| 8:35 am – 9:00 am | Tracer Technology: a Tool for Understanding Sediment Transport Processes and Determining Pathways, Rate and Fate of Transport in Coastal Environments
Jonathan Marsh, ETS Worldwide Unlimited |
| 9:00 am – 9:25 am | International Barrier Island and Beach Restoration Experiences
Adam Hosking, CH2M Hill |

9:25 am – 9:50 am Reestablishing Tidal Channel Ecological Functions: Learning from the Large-Scale Restoration Program along the Arabian Gulf Coastline
Linos Cotsapas, Research Planning, Inc.

Beasts of the Southern Wild (Room 201-202) (93 Minutes)

10:00 am – 10:30 am Morning Break with Refreshments (Exhibit Hall)

10:30 am – 12:00 am Session Block IX

Coastal Resilience: Individual and Community Options (Room 203-204)
Moderator: Robert Gramling, University of Louisiana at Lafayette

10:35 am – 11:00 am Complexities of Resilience: Adaptation and Change within Human Communities of Coastal Louisiana
Conner Bailey, Auburn University

11:00 am – 11:25 am Loss and Adaptation following the BP Oil Spill: Community Cohesion and Social Networks
JoAnne DeRouen, University of Louisiana at Lafayette

11:25 am – 11:50 am The Making of an Inherently Resilient Community: How Drilling for Oil and Oystermen First Collided
Audrey Maass, LSU, Student Presenter

EverView Data Visualization Tool Workshop (Room 205)
Craig Conzelmann, USGS-NWRC, Kevin Suir, USGS-NWRC

Dredge (Panel Discussion) (Room 206)
Moderator: John Headland, Moffatt & Nichol

Panelists: Bill Hanson, Great Lakes Dock and Dredge, Chuck Broussard, Weeks Marine, Inc., Russ Joffrion, CPRA

Waves and Wetlands II (Room 207)
Moderator:

10:35 am – 11:00 am Wind Effects on Nonlinear Interactions of Shallow Water Waves
Ke Liu, LSU, Student Presenter

11:00 am – 11:25 am Passing Vessel Effects on Shorelines and Wetlands
Erin Rooney, HDR

11:25 am – 11:50 am Advancements in Hurricane Storm Surge Modeling Utilizing the ADCIRC Model
Zachary Cobell, Arcadis

LCA Mississippi River Hydrodynamic and Delta Management Study III (Room 208-209)
Moderator: Carol Parsons

10:35 am – 11:00 am Three-Dimensional Hydrodynamic and Sediment Transport

Modeling of the Lower Mississippi River below the Bonnet Carré
Spillway
Joao Pereira, The Water Institute of the Gulf

11:00 am – 11:25 am Numerical Modeling of Sediment Diversions in the Lower
Mississippi River
Ehab Meselhe, The Water Institute of the Gulf

11:25 am – 11:50 am Hydrodynamics and Salinity Modeling in the Lowermost Mississippi
River and Delta
Ioannis Georgiou, UNO

Perspectives on Large-Scale Restoration (Room 210)
Moderator: Angelina Freeman, CPRA

10:35 am – 11:00 am The Atchafalaya River Basin: State of the Science and
Opportunities for Conservation and Restoration
Bryan Piazza, TNC

11:00 am – 11:25 am Keys to Building a Successful Adaptive Management Program
Stuart Appelbaum, Arcadis

11:25 am – 11:50 am Changing Course
Clinton Willson, The Water Institute of the Gulf

CPRA Monitoring Initiatives (Room 211-212)
Moderator: Richard Raynie, CPRA

10:35 am – 11:00 am Louisiana's Coastwide Reference Monitoring System-Wetlands
(CRMS)
Dona Weifenbach, CPRA

11:00 am – 11:25 am Louisiana's Barrier Island Comprehensive Monitoring Program
(BICM): Past, Present, and Future
Darin Lee, CPRA

11:25 am – 11:50 am System-Wide Assessment and Monitoring Program
Richard Raynie, CPRA

Beasts of the Southern Wild (Room 201-202) (93 minutes)

1:30 pm – 3:00 pm

Session Block X

Human and Neighborhood Scale Adaptation (Room 203-204)
Moderator: Stephanie Powell, NWF

1:35 pm – 2:00 pm Influences on Household and Community-Level Mitigation Efforts
and Adaptations to Coastal Hazards in Louisiana
Emily Gootee, LSU, Student Presenter

2:00 pm – 2:25 pm Accessing and Interpreting Coastal Restoration
Amanda Moore, NWF

2:25 pm – 2:50 pm Retrofitting Communities through Planning and Design to be More
Resilient
Patrick Michaels, LSU

EverView Data Visualization Tool Workshop (Room 205)
Craig Conzelmann, USGS-NWRC, Kevin Suir, USGS-NWRC

Emergent Deltas I (Room 206)
Moderator: James Pahl, CPRA

- | | |
|-------------------|--|
| 1:35 pm – 2:00 pm | Hydrodynamic Energy Regimes in the Wax Lake
Chunyan Li, LSU |
| 2:00 pm – 2:25 pm | Long-term Wetland Surface Changes in the Atchafalaya Delta
Guerry Holm, CH2M Hill |
| 2:25 pm – 2:50 pm | Productivity and Resilience in the Plant Community of the Wax Lake Delta and Adjacent Mainland Marshes
Melissa Carle, LSU |

Hurricane Sediment Transport (Room 207)
Moderator: Tonja Kook, Gaea Consultants

- | | |
|-------------------|---|
| 1:35 pm – 2:00 pm | The Sedimentary Signature of Hurricane Isaac in Coastal Wetlands along the Western Edge of Lake Pontchartrain
Kam-biu Liu, LSU |
| 2:00 pm – 2:25 pm | Shelf Sediment Transport during Hurricanes Katrina and Rita
Kehui Xu, LSU |
| 2:25 pm – 2:50 pm | A Hurricane Impact History of Frenier Louisiana from Sedimentary Processes
Gregory Keller, LSU, Student Presenter |

Tools for Visualizing the Lower Mississippi River (Room 208-209)
Moderator: Alisha Renfro, NWF

- | | |
|-------------------|---|
| 1:35 pm – 2:00 pm | The Expanded Small Scale Physical Model of the Lower Mississippi River
Rudolph Simoneaux, Coastal Protection and Restoration Authority |
| 2:00 pm – 2:25 pm | Demystifying the Sediment Diversion: Visualizing Precedent, Intervention, and Predicted Results
Jeffrey Carney, LSU |
| 2:25 pm – 2:50 pm | River Diversions: Mineral Sediment Input and Marsh Loss
Ronnie Paille, USFWS |

2017 Master Plan Modeling Presentations (Room 210)
Moderator: Jenneke Visser, University of Louisiana at Lafayette

- | | |
|-------------------|---|
| 1:35 pm – 2:00 pm | 2017 Model Improvement Plan Overview
Mandy Green, CPRA |
| 2:00 pm – 2:25 pm | Incorporating New Processes: Sediment Distribution and Marsh Edge Erosion
Alex McCorquodale, University of New Orleans |
| 2:25 pm – 2:50 pm | Coastal Louisiana Barrier Island Morphology Modeling: A Hybrid Approach
Michael Poff, Coastal Engineering Consultants |

Mapping and Modeling Coastal Change (Room 211-212)
Moderator: Margaret Reams, LSU

- | | |
|-------------------|--|
| 1:35 pm – 2:00 pm | Persistence and Change – Mapping Community Resilience in |
|-------------------|--|

	Coastal Louisiana, 1930-2010 Scott Hemmerling, The Water Institute
2:00 pm – 2:25 pm	A Method for Knowledge Integration and Mapping to Inform and Enhance Future Coastal Planning and Implementation Efforts Matthew Bethel, Louisiana SeaGrant
2:25 pm – 2:50 pm	Modeling Land Use and Land Cover Changes in Coastal Louisiana Using Artificial Neural Network Yi Qiang, LSU

Beasts of the Southern Wild (Room 201-202) (93 minutes)

3:00 pm – 3:30 pm Afternoon Break with Refreshments (Exhibit Hall)

3:30 pm – 5:00 pm Session Block XI

Designing and Adaptations to Changing Environments (Room 203-204)
Moderator: Joanne Derouen, University of Louisiana at Lafayette

3:35 pm – 4:00 pm	From Boat-to-Fork: Lessons Learned from Market-Based Adaptation in Delcambre Candace May, University of Louisiana at Lafayette
4:00 pm – 4:25 pm	Community Elevation: A Case Study of Delcambre, LA Bob Gramling, University of Louisiana at Lafayette
4:25 pm – 4:50 pm	Adaptive Land and Water Management on the Coast: From Agriculture to Aquaculture in Pecan Island, LA Kari Smith, University of Louisiana at Lafayette

WIFI Room (Room 205)

Emergent Deltas II (Room 206)
Moderator: Angelina Freeman, CPRA

3:35 pm – 4:00 pm	Spatial and Seasonal Variability of Sediment Respiration and Nutrient Fluxes in a Developing Subdelta: the Wax Lake Delta Atchafalaya River Delta Estuary Ciara Chambers, LUMCON, Student Presenter
4:00 pm – 4:25 pm	Tidal Modulated Flow and Sediment Flux through Wax Lake Delta Distributary Channels: Implications for Delta Development Kevin Hanegan, Student Presenter
4:25 pm – 4:50 pm	Sediment Distribution in the Wax Lake Delta-Marshlands: Implications to River Diversions Harry Roberts, LSU

Wave Reduction (Room 207)
Moderator:

3:35 pm – 4:00 pm	An Assessment of the Performance of Raccoon Island Breakwater Projects Glen Curole, CPRA
4:00 pm – 4:25 pm	Measurement of Wave-Induced Current Velocity in Salt Marsh of Terrebonne Bay, LA Arash Karimpour, LSU

Proof we can make a cleaner future happen today.



I'm proud that Entergy was the first American utility to voluntarily reduce greenhouse gases. When compared with the top 10 U.S. electricity producers, we are one of the cleanest in the country. Learn how you can help us save the environment at entergylouisiana.com.

Tiffany Ragan, Customer Service Specialist



Entergy[®]

THE POWER OF PEOPLE[®]



A message from Entergy Louisiana, LLC ©2011 Entergy Services, Inc. All Rights Reserved.



listen. think. deliver.®

Water
Environment
Transportation
Energy
Facilities



**CDM
Smith**®
cdmsmith.com

*CDM Smith is proud to be a Platinum Sponsor of the
2014 State of the Coast conference.*

Offices Throughout Louisiana

4:25 pm – 4:50 pm Investigation of Relationship between Wave Power and Shoreline Retreat in Terrebonne Bay, Southern Louisiana
Kyle Parker, LSU, Student Presenter

Restoration Lessons from the Geological Record (Room 208-209)
Moderator:

3:35 pm – 4:00 pm Using the Late Holocene Stratigraphic Record to Guide Mississippi Delta Restoration
Zhixiong Shen, Tulane University

4:00 pm – 4:25 pm Using the Late Holocene Stratigraphic Record to Guide Mississippi Delta Restoration: Constraining Subdelta Progradation Rates
Elizabeth Chamberlain, Tulane University, Student Presenter

4:25 pm – 4:50 pm Eco-Geomorphologic Evolution of the Brazos River Delta in the last 10,000 years: A Case Study of the Texas Upper Coast
Juan Moya, Atkins

2017 Master Plan Modeling (Room 210)
Moderator: Natalie Peyronnin, Environmental Defense Fund

3:35 pm – 4:00 pm Improving Fish and Wildlife Predictions
Denise Reed, The Water Institute of the Gulf

4:00 pm – 4:25 pm Developing Future Uncertainty Scenarios
Ehab Meselhe, The Water Institute of the Gulf

4:25 pm – 4:50 pm Extended Audience Questions on Integrating Approaches for the 2017 Coastal Master Plan

Measuring Success of Coastal Restoration (Room 211-212)
Moderator: Jeff Carney, LSU

3:35 pm – 4:00 pm Assessing Coastal Community Resilience in Louisiana and the Netherlands: Conceptual and Methodological Challenges
Ryan Kirby, LSU, Student Presenter

4:00 pm – 4:25 pm Restoring Freshwater Wetlands – Keeping Saline Waters at Bay for LaBranche
Maarten Kluijver, Moffatt & Nichol

4:25 pm – 4:50 pm A Legal & Cost Analysis of Rapid Land-Building Technologies in the Netherlands and Louisiana
Megan Biven

Filmmaking and the Role of the Arts in Coastal Protection and Restoration (Panel Discussion) (Room 201-202)

Film: Can't Stop the Water (38 minutes)

Moderator: Mike Pasquier, LSU

Panelists: Glen Pitre, Zack Godshall, Casey Coleman, Rebecca Ferris, Monique Verdin



Sustainable solutions for coastal restoration

ARCADIS offers innovative solutions to preserve and restore Louisiana coastal lands and waters. ARCADIS' workable solutions significantly reduce risk while bolstering restoration success and expediting project closure. Our advanced, proven approaches are built upon global, leading-edge technologies balanced with local scientific and engineering experience.

Recent Louisiana Projects:

- Hydrodynamic modeling for the Coastal Protection and Restoration Authority's 2012 and 2017 Coastal Master Plan
- Plaquemines Parish Vegetative Ridge Program
- Program Management for The Water Institute of the Gulf
- Evaluation of Levee Board Consolidations in Louisiana
- Southwest Coastal Feasibility Study
- Lake Pontchartrain Barrier Feasibility Study

www.arcadis-us.com

Baton Rouge
Metairie
New Orleans

Imagine the result

 **ARCADIS**
Infrastructure · Water · Environment · Buildings



THE WATER INSTITUTE OF THE GULF



**INTEGRATING
APPLIED RESEARCH**



**LINKING
KNOWLEDGE TO ACTION**



**BUILDING
PARTNERSHIPS**

WWW.THEWATERINSTITUTE.ORG

301 NORTH MAIN STREET, SUITE 2000 • BATON ROUGE LA 70825 • 225-448-2813 • INFO@THEWATERINSTITUTE.ORG

Inspiring Americans to Protect Wildlife for our Children's Future

Mississippi River Delta Restoration Program
8222 Maple Street
New Orleans, Louisiana 70118
504-273-4838
www.mississippiriverdelta.org



NEW!

Special release
of first copies to
SOC attendees.

The Atchafalaya River Basin *History and Ecology of an American Wetland*

BRYAN P. PIAZZA

Comprised of almost a million acres, the Atchafalaya River Basin supports one of North America's greatest biodiversity treasure troves. It also provides critical flood protection for millions, hosts a crucial nerve center of American and global commerce, and is the heartbeat of the Cajun culture. Sustainable management practices are necessary to protect this delicate balance between ecology, economy, and culture. Existing and emerging threats pose management challenges and have the basin on an unsustainable trajectory.

BRYAN P. PIAZZA, freshwater and marine science director at The Nature Conservancy, Louisiana, documents the ecological state of the basin, provides research for future planning, and identifies urgent but unexplored scientific questions in need of answers. He provides positive direction for navigating the basin's complexities now in order to preserve its (and our) future.

8½x11. 320 pp. 132 color, 4 b&w illus. 25 maps. 12 tables.
4 appendixes. Bib. Index. \$35.00 **\$24.50** hardcover

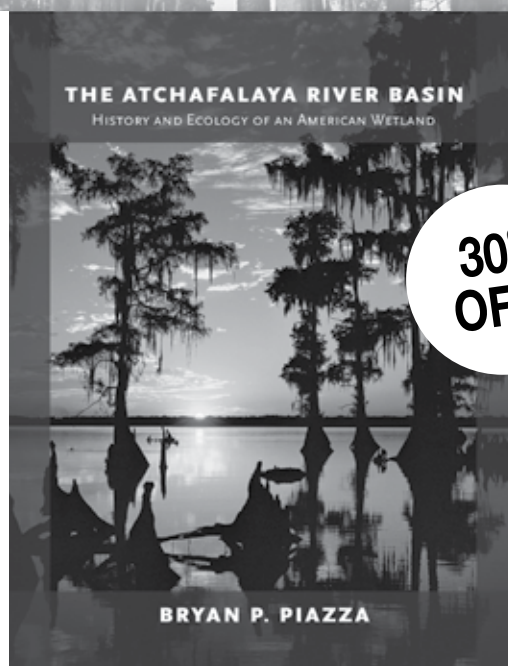

AUTHOR WILL BE PRESENT TO SIGN COPIES

ATM | TEXAS A&M UNIVERSITY PRESS
www.tamupress.com • 800-826-8911

The Nature
Conservancy
Protecting nature. Preserving life.™

Booths
61 & 62

POSTER PRESENTATIONS

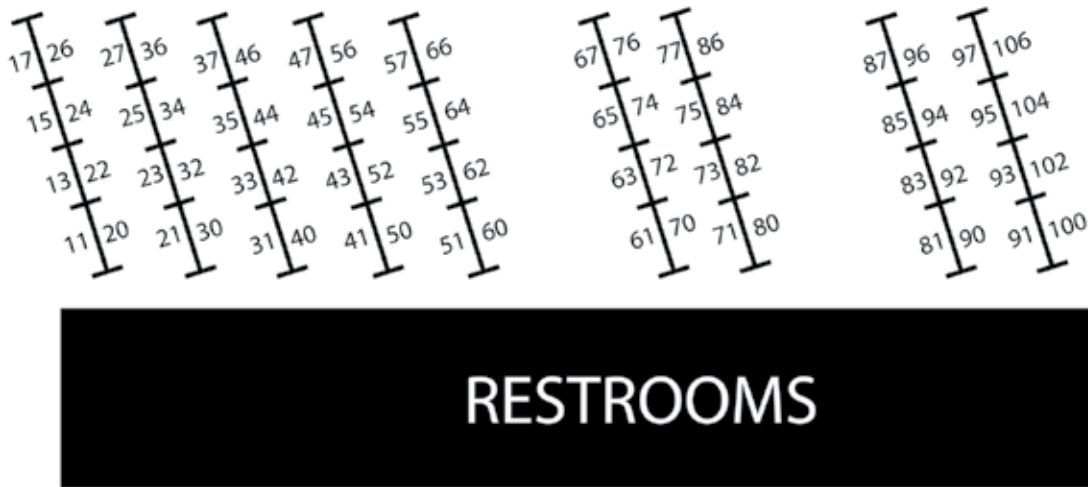

POSTER LOCATIONS

ADAPTIVE MANAGEMENT

1. Implications of Beach Restoration on Piping Plover (*Charadrius melodus*) on the Caminada Headland Beach and Dune Restoration Project
Delaina LeBlanc, Barataria-Terrebonne National Estuary Program
10. Developing Coastal Wetland Management on the Chenier Plain using Geospatial Analysis of Natural and Anthropogenic Land Change
D. Stephen Nevitt II, University of Louisiana at Lafayette - Student Presenter

BARRIER ISLANDS AND SHORELINES

11. Monitoring Coastal Erosion at Near-Shore Structures in Southwest Louisiana
Amit Sharma, McNeese State University - Student Presenter

COMMUNITY RESILIENCE

13. Shrink NOLA to Save NOLA
Ian Brown, Louisiana State University - Student Presenter
15. Art + the Louisiana Coast
Shelby Doyle, Louisiana State University

POSTER LOCATIONS CONT.

- 17. Integrating Natural Infrastructure into Urban Coastal Resilience:
Howard Beach, New York City
Luce Bassetti, CH2M Hill
- 20. Coastal Forest Conservation for Ecosystem Benefits and Community Resilience
Honora Buras, Coastal Protection and Restoration Authority
- 22. Coastal Resiliency: From Agriculture to Aquaculture
Melissa Chapman, University of Louisiana at Lafayette - Student Presenter

DEEPWATER HORIZON OIL SPILL

- 23. Potential Effects of 2010 Deepwater Horizon Oil Spill on Denitrification Rates of Louisiana Coastal Wetland Soil
Jason Pietroski, Louisiana State University - Student Presenter
- 24. Physiological Recovery of Smooth Cordgrass (*Spartina alterniflora* Loisel) in Barataria Bay after Deepwater Horizon Oil Spill
Noble Opusunju, Xavier University - Student Presenter
- 25. Near Real-Time Determination of Volatile Organic Compounds in Air and Water Samples Associated with Dispersed Crude Oil
Parichehr Saranjampour, Louisiana State University - Student Presenter

DIVERSIONS

- 26. Wildlife and Fisheries Responses to Diversions
David Lindquist, Coastal Protection and Restoration Authority
- 27. River Diversions as a Component of Louisiana's Integrated Master Plan, and Potential Effects of Diversion Flows on Receiving Basins
James Pahl, Coastal Protection and Restoration Authority
- 30. Sustainability of Wetland Soils and Vegetation Receiving Diversion Flows
James Pahl, Coastal Protection and Restoration Authority
- 31. Constructed and Proposed Diversions, Spillways, and Siphons in South Louisiana
Carol Parsons-Richards, Coastal Protection and Restoration Authority
- 32. West Bay Sediment Diversion: Review of Design, Progress and Effects
Erin Plitsch, Coastal Protection and Restoration Authority
- 33. Water Quality in Adjacent Open Water Bodies Receiving Diversion Inflows
Richard Raynie, Coastal Protection and Restoration Authority
- 34. Land Building from the Delivery of River Sediments to Intertributary Basins
Brian Vosburg, Coastal Protection and Restoration Authority
- 35. Do Constructed Crevasses Obey Delta Laws? Implications for the Restoration of the Mississippi River Delta
Tara Yocum, University of New Orleans - Student Presenter

-
36. Wetland Vegetation Dynamics and Ecogeomorphology in the West Bay Diversion, LA
Alex Ameen, Tulane University

HISTORICAL / CURRENT STATUS OF COASTAL RESOURCES

40. MRHDMS Data Delivery & Online Visualization
Craig Conzelmann, U.S. Geological Survey National Wetlands Research Center
41. Emergent Wetlands Status and Trends in the Northern Gulf of Mexico: 1950-2010
Kate Spear, U.S. Geological Survey National Wetlands Research Center
42. Coastal Vegetation Types in Louisiana in 2013
Jenneke Visser, University of Louisiana at Lafayette

HURRICANES

43. Hurricane IKE (2008) Simulation Experiment using WRF
Linlin Cui, Louisiana State University - Student Presenter
44. Characterization of Historic Sedimentation and Coupled Natural-Human Dynamics in a Vulnerable Region of Coastal Louisiana
Jonathan Lambert, Louisiana State University - Student Presenter
45. Storm Surge Effects on the Distribution of Salinity in the Wetland Soils of Coastal Marshes in the Wax Lake Delta, LA
Morgan McKee, Louisiana State University - Student Presenter

INNOVATIVE TOOLS

46. Shoreline Green Infrastructure - The Next Generation of Resilient Techniques
Ed Morgereth, Biohabitats, Inc.
47. Engineered Oyster Reef Breakwaters on the Gulf Shoreline of Louisiana
Tyler Ortego, ORA Estuaries/Wayfarer Environmental Technologies
50. Wave Robbers™: Erosion Control and Land Reclamation Preliminary Function Evaluation, Field Evaluation, and Design Refinement Study
Nicholas McCoy, University of Louisiana at Lafayette - Student Presenter
51. CPRA Research Support
Summer Langlois, Coastal Protection and Restoration Authority
53. Development of *Spartina spartinae* Lines for Improved Seed Production and Viability for Restoration Along the Gulf Coast
Garret Thomassie, U.S. Department of Agriculture Natural Resources Conservation Service

POSTER LOCATIONS CONT.

- 54. Vegetative Releases for Beach, Marsh, and Estuary Restoration in South Louisiana
Garret Thomassie, U.S. Department of Agriculture Natural Resources Conservation Service
- 55. Louisiana Coastal Protection and Restoration Authority Coastal Information Management System (CIMS)
Charles Villarubia, Coastal Protection and Restoration Authority
- 56. Development of a Vegetative Volume Index for the Coastwide Reference Monitoring System-Wetlands
Bernard Wood, Coastal Protection and Restoration Authority
- 57. Optimizing the Design of Shoreline Protection to Reduce Marsh Edge Erosion for Louisiana Coastal Protection and Restoration
Agnimitro Chakabarti, Louisiana State University - Student Presenter
- 60. Legal Aspects of Wetland Creation and Carbon Capture for Coastal Louisiana
Casey Pickell, Louisiana State University - Student Presenter
- 95. The 2012 Coastal Master Plan as a Vehicle for Improving Undergraduate Education in Engineering, Hydrology, and Coastal Sciences
Madeleine Bodin, University of Louisiana at Lafayette - Student Presenter

LESSONS LEARNED

- 61. USACE Mitigation at Manchac Wildlife Management Area
Getrisc Coulson, U.S. Army Corps of Engineers
- 62. Bayou LaBranche Wetland Creation (PO-17): What Have We Learned From Two Decades of Monitoring?
Danielle Richardi, Coastal Protection and Restoration Authority
- 63. Elevation Change in a Sediment-Slurry Amendment Restoration Site in Port Fourchon, LA
Scott Jones, University of Louisiana at Lafayette - Student Presenter

LIVING RESOURCES AND MONITORING

- 64. An Examination of Various Socio-Economic Indicators in a Louisiana Oyster Fishery
Jason Shackelford, SWCA Environmental Consultants
- 65. Effects of Invasive Fire Ant Establishment and Subsequent Treatment on Brown Pelican Nest Success in the Gulf of Mexico
Brock Geary, Tulane University - Student Presenter
- 66. Analytical Data Tools Employed by Louisiana's Coastwide Reference Monitoring System-Wetlands
Thomas McGinnis, Coastal Protection and Restoration Authority
- 67. The Effect of Beach Nourishment on Piping plovers (*Charadrius melodus*) and Infaunal Invertebrate Communities on Louisiana Barrier Islands
Jessica Schulz, University of Louisiana at Lafayette - Student Presenter

-
- 70. Salinity and Fertilization Effect on Growth and Biomass of *Typha domingensis*
Bobby Wells Soukanh, University of Louisiana at Lafayette - Student Presenter
 - 71. Assessment of the Habitat Value and Edge Effect of Different Wetland Restoration Techniques for Waterbirds in Southeastern Louisiana
Lauren Sullivan, Louisiana State University - Student Presenter
 - 72. Management and Economic Implications of Oyster Harvest Areas in Louisiana
Morgan Taylor, Louisiana State University - Student Presenter
 - 73. Coastal Ecology of Louisiana Carnivores
Mirka Zapletal, University of Louisiana at Lafayette - Student Presenter
 - 96. Alternative Bait for the Louisiana Commercial Blue Crab (*Callinectes sapidus*) Fishery
Nikki Anderson, Louisiana State University - Student Presenter

PHYSICAL AND ECOSYSTEM MODELING

- 74. Cloud Cover, Water Quality, and Spatial Analysis: Enhancements to a Mechanistic Model of Light Dynamics and Phytoplankton Growth in Little Vermillion Bay
Rifat Alam, University of Louisiana at Lafayette - Student Presenter
- 75. Study on Effectiveness of Protection and Restoration Strategy in the Coastal Area of Louisiana
Minhaz Shahriar, Louisiana Tech University - Student Presenter
- 76. Modeling the Effects of Hypoxia on Fish Movement in the Gulf of Mexico Hypoxic Zone
Elizabeth LaBone, Louisiana State University - Student Presenter
- 77. Preliminary Investigation of Uncertainties in Future Conditions of Exogenous Environmental Factors used in the Master Plan Predictive Models
Selina Jahan Sumi, University of Louisiana at Lafayette - Student Presenter

REGIONAL SEDIMENT MANAGEMENT

- 80. Application of LASARD to Large Scale Modeling in MRHDMS Project
Andrew Crabb, BEM Systems, Inc.
- 81. Regional Surficial Sediment Distribution Map, Offshore Louisiana
Syed Khalil, Coastal Protection and Restoration Authority
- 82. The Impacts of Different Sediment Sources on the Sedimentation in Calcasieu Ship Channel
Adam Oler, McNeese State University - Student Presenter

RIVER & DELTA DYNAMICS

- 83. Eighty-Year Variability of River Discharge from the Mississippi-Atchafalaya River System (MARS) and the Amite River to the Gulf of Mexico
Ivan Prock, Louisiana State University - Student Presenter



Proven professionals in on-shore and near-shore
marine and disaster operations.

24 Hour Contact Line - 601-951-3981



Dynamic Solutions
LLC

Baton Rouge, LA • Knoxville, TN • Tallahassee, FL • Vicksburg, MS
450 Laurel St, Suite 1060
Baton Rouge, LA 70801
225-490-0090
www.dsllc.com

Specialists in hydrodynamic, sediment transport, water quality, and ecological modeling



Lake Borgne Storm Surge Barrier



Cole's Bayou Marsh Restoration



Myrtle Grove Ecological Model

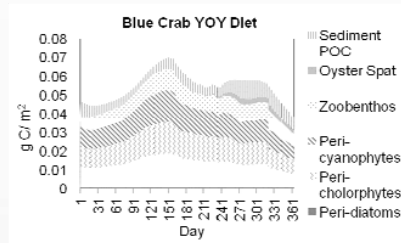
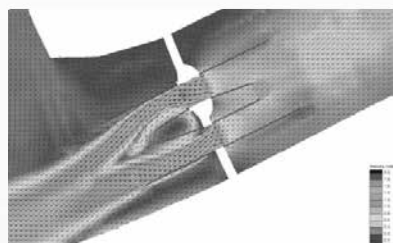

Professional Services

- | | |
|--------------------------------------|-----------------------------------|
| 3 Dimensional Water Quality Modeling | • Minimum Flows and Levels (MFLs) |
| 2 and 3-D Hydrodynamic Modeling | • Toxics Transport and Fate |
| Sediment Transport Modeling | • TMDL Analyses |
| Ecological Modeling | • Flood Studies |



COASTAL WETLANDS PLANNING, PROTECTION AND RESTORATION ACT

PUBLIC OUTREACH COMMITTEE

700 CAJUNDOME BOULEVARD • LAFAYETTE, LA 70506

OFFICE: (337) 266-8623 OR (337) 266-8542

MANAGING AGENCIES:



Restoring Coastal Louisiana Since 1990

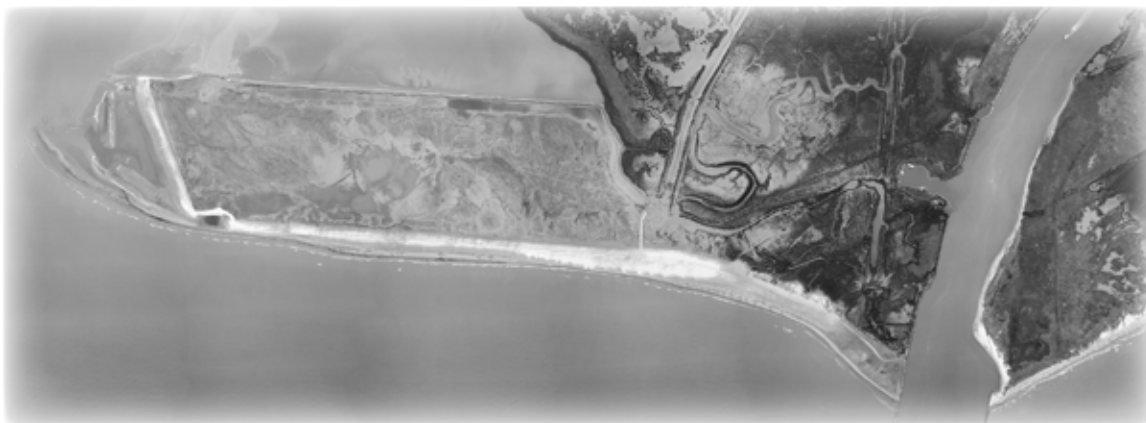

Celebrating our 100th Completed Project

TE-52 West Belle Pass Barrier Headland Restoration

CONNECT WITH US:



[FACEBOOK.COM/CWPPRA](https://www.facebook.com/CWPPRA)



[TWITTER.COM/CWPPRA](https://twitter.com/CWPPRA)



[FLICKR.COM/PHOTOS/CWPPRA/SETS](https://www.flickr.com/photos/cwppra/sets)



[CWPPRA.WORDPRESS.COM](https://www.cwppra.wordpress.com)



[YOUTUBE.COM/CWPPRACLIPS](https://www.youtube.com/cwppraclips)

WWW.LACOAST.GOV

POSTER LOCATIONS CONT.

- 84. LCA Mississippi River Hydrodynamic and Delta Management Study - Field Observational Studies of Hydrodynamics and Sediment Transport in Lower Mississippi River
Mead Allison, The Water Institute of the Gulf
- 85. Louisiana Coastal Zone Research and Mapping by the Louisiana Geological Survey
Paul Heinrich, Louisiana Geological Survey
- 86. LCA Mississippi River Hydrodynamic and Delta Management Study – One and Multi-Dimensional Modeling
Ehab Meselhe, The Water Institute of the Gulf
- 87. On the Amount of Sediment Deposited in Floodplains from the Mississippi River: A Case Study in Cat Island National Wildlife Refuge, Louisiana
Matthew Smith, Louisiana State University - Student Presenter
- 90. Buried Distributaries as a Conduit for Groundwater Flow in Barataria Bay, Louisiana
Alexander Breaux, Louisiana Universities Marine Consortium - Student Presenter
- 91. Using the Late Holocene Stratigraphic Record to guide Mississippi Delta Restoration: Sediment Budget of a Relict Natural River Diversion
Christopher Esposito, Tulane University - Student Presenter
- 92. Using the Late Holocene Stratigraphic Record to guide Mississippi Delta Restoration: Rates of carbon Sequestration
Krista Jankowski, Tulane University - Student Presenter
- 93. Patterns of Sediment Accumulation over Decadal Timescales in the Breton Sound Basin
James Smith, Louisiana State University - Student Presenter
- 94. Influences of Hurricanes, Floods, and Organic Production on River-Delta Evolution
Crawford White, Louisiana State University - Student Presenter

WATER QUALITY

- 97. A Watershed Education: Water Quality Monitoring and GIS Analysis on Bayou Vermilion
Claire Coussan, University of Louisiana at Lafayette - Student Presenter
- 100. Water Quality Impacts Overtime due to Changes in Land Use
Justin Shaw, C. H. Fenstermaker & Associates
- 102. Heavy Metal Transport in the Lower Calcasieu River Basin, Southwest Louisiana
Kaci Fisher, Louisiana State University - Student Presenter
- 104. Heavy Metal Transport and Retention in the Atchafalaya River
Kaci Fisher, Louisiana State University - Student Presenter
- 106. The Occurrence of Stratification Induced Hypoxia near the Chandeleur Islands, LA: Insights into Physical Controls
Jeremy Henley, University of New Orleans - Student Presenter

IT ALL STARTS WITH DREDGING™

ECONOMIC RECOVERY | COASTAL PROTECTION | ENVIRONMENTAL RESTORATION



Dredging at Shell Island, a CPRA project constructed by GLDD



GREAT LAKES DREDGE & DOCK COMPANY, LLC

2122 York Road, Oak Brook, IL 60523 | 630.574.3000 | info@gldd.com | gldd.com
COMMITTED TO CREATING AN INCIDENT- AND INJURY-FREE (IIF) WORK ENVIRONMENT

SOC14 COMMITTEE MEMBERS

Steering Committee

1. Clint Willson—Louisiana State University/Water Institute of the Gulf
2. David Muth—National Wildlife Federation
3. Denise Reed—Water Institute of the Gulf
4. Jeff Duplantis—MWH Global
5. John Ettinger—Environmental Protection Agency
6. Jonathan Hird—Moffat and Nichol
7. Kurt Evans—Digital Engineering and Imaging, Inc.
8. Kyle Graham—Coastal Protection and Restoration Authority
9. Mark Wingate—US Army Corps of Engineers
10. Morgan Crutcher—Coalition to Restore Coastal Louisiana
11. Robert Twilley—Louisiana SeaGrant
12. Steven Peyronnin—Coalition to Restore Coastal Louisiana

Program Committee

1. Alex Kolker—Louisiana Universities Marine Consortium
2. Barbara Keeler—Environmental Protection Agency
3. Barry Keim—Louisiana State University
4. Bryan Piazza—The Nature Conservancy
5. Carey Perry—Coalition to Restore Coastal Louisiana
6. Craig Colten—Water Institute of the Gulf
7. Earl Melancon—Nicholls State University
8. Ioannis Georgiou—University of New Orleans
9. Jeff Carney—Louisiana State University Coastal Sustainability Studio
10. Jenneke Visser—University of Louisiana at Lafayette
11. Jim Pahl—Coastal Protection and Restoration Authority
12. Jonathan Hird—Moffatt & Nichol
13. Kyle Balkum—Louisiana Department of Wildlife and Fisheries
14. Megan Lapeyre—Louisiana State University/US Geological Survey
15. Mike Pasquier—Louisiana State University
16. Morgan Crutcher—Coalition to Restore Coastal Louisiana
17. Natalie Peyronnin—Environmental Defense Fund
18. Nina Reins—MWH Americas, Inc
19. Ralph Libersat—Royal Engineers & Consultants
20. Robert Bourgeois—Louisiana Department of Wildlife and Fisheries
21. Rudy Simoneaux—Coastal Restoration and Protection Authority
22. Sam Bentley—Louisiana State University

Sponsorship Committee

1. Bill Hinsley--Arcadis
2. Bryan Jones--HNTB
3. Chuck Simmons—Coalition to Restore Coastal Louisiana
4. Cynthia Duet--Audubon
5. Gerry Duszynski--Fenstermaker
6. Joe Cancienne--Tetra Tech
7. Luke LeBas--Brown and Caldwell
8. Nedra Davis
9. Nick Speyrer--The Water Institute of the Gulf
10. Phil Precht--Conoco Phillips
11. Randy Smith--Royal Engineers & Consultants
12. Ron Crum--URS
13. Scott Kirkpatrick--Coast Builders Coalition
14. Taylor Marshall--The Water Institute of the Gulf
15. Will Norman--CDM Smith

Student Engagement Committee

1. Alisha Renfro—National Wildlife Federation
2. Bob Thomas—Loyola University
3. Carey Perry—Coalition to Restore Coastal Louisiana
4. Chrystal Landgraf—Motiva Norco
5. Erin Rooney—HDR Engineering, Inc.
6. Harish Ratnayaka—Xavier University
7. Janet Woolman—McNeese State University
8. Jori Erdman—Louisiana State University
9. Marisa Escudero—Land Trust for Southeastern Louisiana
10. Matthew Bethel—Louisiana SeaGrant
11. Murty Kambhampati—Southern University New Orleans
12. Rob Moreau—Southeastern Louisiana University
13. Susan Testroet-Bergeron—CWPPRA
14. Tiffany Warner—Louisiana State University
15. Whitney Broussard—University of Louisiana at Lafayette

EXHIBIT HALL MAP

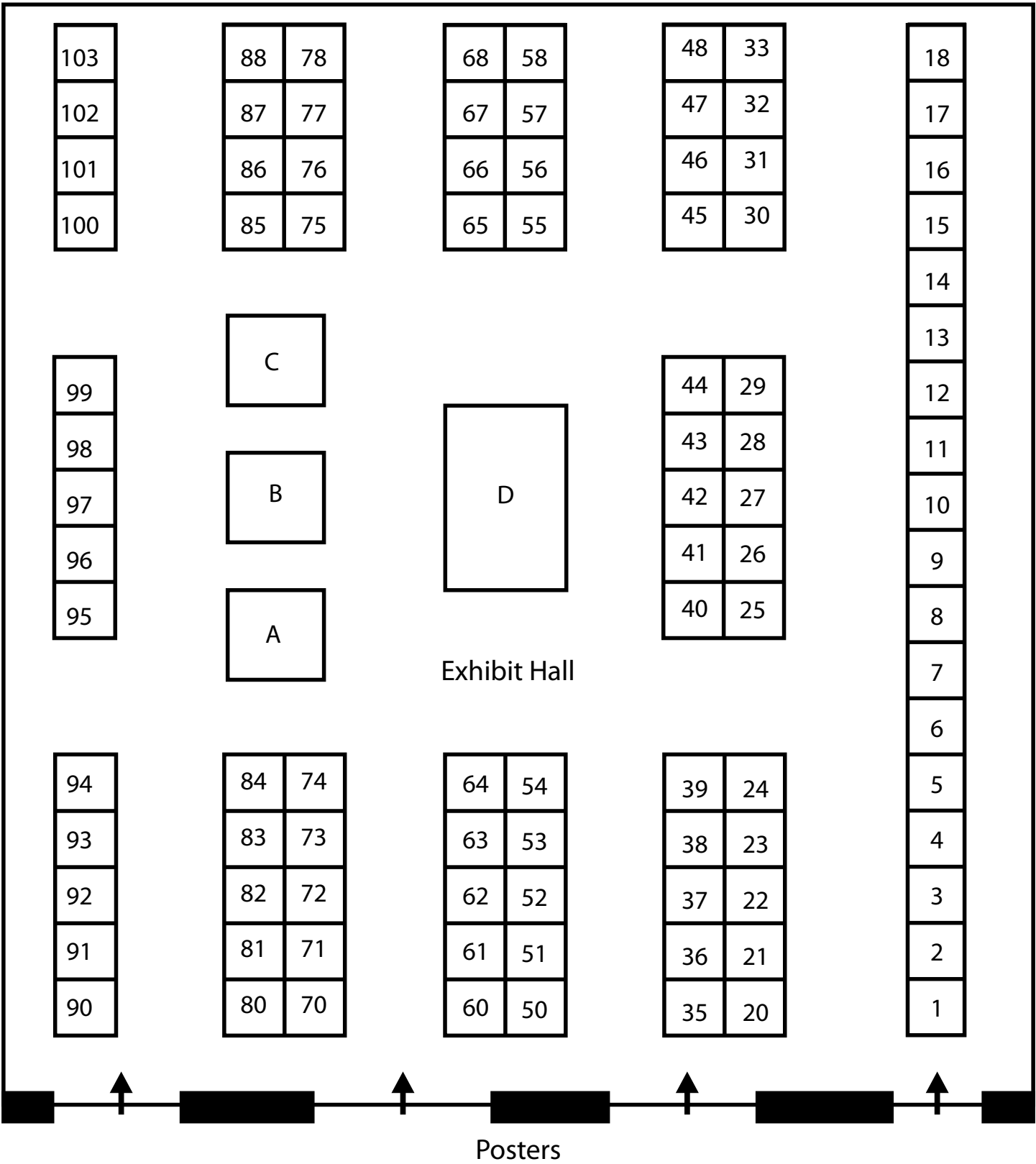

EXHIBITOR CONTACT INFORMATION

- A Coastal Protection and Restoration Authority (CPRA)
Contact: Chuck Perrodin
P.O. Box 44027
Baton Rouge, LA 70804-4027
Phone: 225.342.7615
Email: chuck.perrodin@la.gov
- B Coalition to Restore Coastal Louisiana (CRCL)
Contact: Kelly Messer
6160 Perkins Road, Suite# 225
Baton Rouge, La 70808
Phone: 225.767.4181
Email: kellym@crcl.org
- C The Water Institute of the Gulf (TWIG)
Contact: Taylor Marshall
One American Place
301 N. Main Street, Suite 2000
Baton Rouge, LA 70825
Phone: 225.227.2723
Email: tmarshall@thewaterinstitute.org
- D Premier Concrete and Industrial Fabrics
Contact: Cary Goss
510 O'Neal Ln
Baton Rouge, Louisiana 70808
Phone: 225.906.0761
Email: jcollins@ind-fab.com
- 1 Neel Schaffer
Contact: Jerry Trumps
314 Audubon Blvd
Lafayette, LA 70503
Phone: 337.232.6111
Email: jerry.trumps@neel-schaffer.com
- 2 Digital Engineering
Contact: Whitney Watson
527 W. Esplanade Ave, Ste 200
Kenner, LA 70065
Phone: 504.468.6129
Email: wwatson@deii.net
- 3 Phillips 66
Contact: Melissa Ory
PO Box 176
Belle Chasse, LA 70037
Phone: 504.656.3987
Email: Melissa.R.Ory@p66.com
- 4 R. Christopher Goodwin & Associates, Inc.
Contact: James Schmidt
309 Jefferson Highway, Ste. A
New Orleans, LA 70121
Phone: 1-800-340-2274
Email: sschmidt@rcgoodwin.com
- 5 SWCA Environmental Consultants
Contact: Jason Shackelford
5745 Essen Lane, Ste. 105
Baton Rouge, LA 70810
Phone: 225.663.3830
Email: JShackelford@swca.com
- 6 Dewberry
Contact: Rebecca Hernandez
1615 Poydras Street, Suite 1295
New Orleans, LA 70112
Phone: 504.872.3769
Email: rhernandez@Dewberry.com
- 7 GeoEngineers, Inc.
Contact: David Eley
11955 Lakeland Park Blvd., Ste. 100
Baton Rouge LA 70809
Phone: 225.293.2460
Email: deley@geoengineers.com
- 8 Deltares USA / Deltares Netherlands
Contact: Edwin Welles
Deltares USA, Inc
8070 Georgia Ave, Suite 303
Silver Spring, MD 20910
Phone: 301.642.2505
Email: edwin.welles@deltares-usa.us
- 9 Restore or Retreat
Contact: Simone Maloz
PO Box 2048 - NSU
Thibodaux, LA 70310
Phone: 985.448.4485
Email: simone.maloz@nicholls.edu
- 10 MWH
Contact: Jeff Sapia
7742 Office Park Blvd., C-2
Baton Rouge, La 70809
Phone: 225.926.3991
Email: Jeffrey.P.Sapia@mwhglobal.com

EXHIBITOR CONTACT INFORMATION CONT.

- | | |
|--|--|
| <p>11 Lonnie Harper & Associates
Contact: Leonard Harper
2746 Hwy 384
Bell City, LA 70630
Phone: 337.905.1079
Email: leonard@harper-group.com</p> <p>12 Atkins
Contact: Karen Bessem-Asu
One Galleria Boulevard, Suite 1516
Metairie, LA 70001
Phone: 504.841.2226
Email: Karen.Bessum-Asu@atkinsglobal.com</p> <p>13 Coast & Harbor Engineering Inc
Contact: Josh Carter
228 St. Charles Ave, Ste 1330A
New Orleans, LA 70130
Phone: 704.383.9785
Email: josh@coastharboreng.com</p> <p>14 Southern Earth Sciences
Contact: Penny Hatcher
6352 Piccadilly Square Dr.
Mobile, AL 36609
Phone: 251.445.4270
Email: phatcher@soearth.com</p> <p>15 Forrest Keeling Nursery
Contact: Kim Young & Mike Thompson
88 Forrest Keeling Lane
Elsberry, Missouri 63343
Phone: 636.358.4724
Email: mthompson@fknursery.com</p> <p>16 Hach Hydromet/ Sea-Bird
Contact: David Procyk
5600 Lindbergh Drive
Loveland, CO 80539
Phone: 512.288.5831
Email: dprocyk@hach.com</p> <p>17 Clean Water, Land & Coast
Contact: John Carmouche
17405 Perkins Rd.
Baton Rouge, LA 70810
Phone: 225.400.9991
Email: info@cleanwaterlandcoast.com</p> <p>18 Gulf Coast Aggregates
Contact: Ed Reardon
22230 Main Street
Abita Springs, LA 70420
Phone: 985.630.2429
Email: eereardon@aol.com</p> | <p>20 Stream Wetland Services, L.L.C.
Contact: Dean Roberts
PO Box 40
Lake Charles, LA 70602
Phone: 337.433.1055
Email: droberts@streamcompany.com</p> <p>21 LSU School of the Coast and Environment
Contact: Mary E Bergeron
Louisiana State University
1002-Q Energy, Coast & Environment Building
Baton Rouge, LA 70803
Phone: 225.578.3381
Email: mberg41@lsu.edu</p> <p>22 Tensar International Corp
Contact: Kristin Ezen
2500 Northwinds Parkway, Ste 500
Alpharetta, GA 30009
Phone: 770.344.2090
Email: kezen@tensarcorp.com</p> <p>23 LSU Press
Contact: Kate Barton
3990 West Lakeshore Drive
Baton Rouge, LA 70808
Phone: 225.578.8650
Email: kbarto4@lsu.edu</p> <p>24 LSU Coastal Sustainability Studio
Contact: Jeff Carney
212 Design Bldg, LSU
Baton Rouge, LA 70803
Phone: 225.252.4390
Email: jcarney@lsu.edu</p> <p>25 Morris P. Hebert, Inc. (MPH)
Contact: John Speice
283 Corporate Dr
Houma, LA 70361
Phone: 985.853.3948
Email: jspeice@mphinc.com</p> <p>26 Reef Ball Foundation
Contact: Jim McFarlane
2415 Mc Michael Road
St. Cloud, FL 34771
Phone: 352.262.8660
Email: mcfarlane@alumni.ufl.edu</p> |
|--|--|

-
- 27 Brown & Caldwell
Contact: Luke Lebas
451 Florida Street, Suite 1050
Baton Rouge LA 70801-1704
Phone: 225.456.2504
Email: llebas@BrwnCald.com
- 29 Ducks Unlimited
Contact: Bob Dew
806 Bayou Black Drive
Houma, LA 70361
Phone: 985.853.3020
Email: bdew@ducks.org
- 30 CH2M HILL
Contact: Carlos Giron
700 Main Street, Suite 400
Baton Rouge, LA 70802
Phone: 225.663.5190
Email: carlos.giron@ch2m.com
- 31 4-H Youth Wetlands Education and Outreach Program
Contact: Ashley Mullens
176 Knapp 110 LSU Union Square
Baton Rouge, LA 70803
Phone: 225.278.1980
Email: awmullens@agcenter.lsu.edu
- 32 Integrated Logistical Support Inc. (ILSI Engineering)
Contact: Iam C. Tucker
1100 Poydras Street Suite 2775
New Orleans, Louisiana 70163
Phone: 504.523.1619
Email: corporate@ilsiengineering.com
- 33 Ocean Surveys, Inc.
Contact: John Sullivan
129 Mill Rock Road, East
Old Saybrook, CT 06413
Phone: 860.388.4631
Email: jds@oceansurveys.com
- 35 LA 1 Coalition
Contact: Henri Boulet
P.O. Box 2048-NSU
Thibodaux, LA 70310
Phone: 985.448.4485
Email: henri.boulet@nicholls.edu
- 36 Ben Gerwick/COWI
Contact: Dennis Lambert
400 Poydras St., Suite 1160
New Orleans, LA 70130
Phone: 504.528.2004
Email: delm@gerwick.com
- 37 DHI Water & Environment
Contact: Dale Kerper
305 Stevens Avenue, Suite 205
Solana Beach, CA 92075
Phone: 760.697.1006
Email: drk@DHIGroup.com
- 38 C-LOG Marine
Contact: Alex Murray
2510 14th Street Suite 1425
Gulfport, Mississippi 39501
Phone: 228.342.0120
Email: alex@c-logmarine.com
- 39 Fenstermaker
Contact: Gerry Duszynski
445 North Blvd, Ste 601
Baton Rouge, LA 70802
Phone: 225.344.6701
Email: gerald@fenstermaker.com
- 40 Moffatt & Nichol
Contact: Tracy Russell-Beck
301 Main Street, Suite 800
Baton Rouge, LA 70825
Phone: 919.781.4626
Email: trussell-beck@moffattnichol.com
- 41 CDM Smith
Contact: Will Norman
445 North Blvd, Ste 850
Baton Rouge, LA 70802
Phone: 225.663.3037
Email: normancw@cdm.com
- 42 Weeks Marine, Inc.
Contact: Chuck Broussard
304 Gaille Drive
Covington, La 70433
Phone: 985.875.2500
Email: crbroussard@weeksmarine.com

EXHIBITOR CONTACT INFORMATION CONT.

- 44 URS Corporation
Contact: Ron Crum
7389 Florida Boulevard, Suite 300
Baton Rouge, LA 70806-4657
Phone: 225.922.5700
Email: ron.crum@urs.com
- 45 USDA-NRCS
Contact: Britt Paul
3734 Government Street, Building C
Alexandria, LA 71302
Phone: 318-473-7756
Email: britt.paul@la.usda.gov
- 46 Martin Eco Systems
Contact: Nicole Waguespack
5819 McCann Dr
Baton Rouge, LA 70809
Phone: 225.292.6750
Email: nicole@MartinEcosystems.com
- 47 LSU Center for GeoInformatics
Contact: Joshua Kent
101 LSU Student Union Bldg
LSU Box 25413
Baton Rouge, LA 70803
Phone: 225.578.5260
Email: jkent4@lsu.edu
- 48 Walter Marine
Contact: David Walter
P.O. Box 998
Orange Beach, AL 36561
Phone: 251.979.2200
Email: reefmaker@gulftel.com
- 50 FTN Associates
Contact: Ranjit Jadhav
10508 N. Glenstone Place
Baton Rouge, LA 70810
Phone: 225.766.0586
Email: rsj@ftn-assoc.com
- 51 T. Baker Smith
Contact: Christina Tucker
PO Box 2266
Houma, LA 70361
Phone: 985.868.1050
Email: christina.tucker@tbsmith.com
- 52 Gaea Consultants
Contact: Tonja Koob
536 Washington Ave
New Orleans, LA 70130
Phone: 504.962.5360
Email: tonja.koob@gaeaconsultants.com
- 53 Environmental Defense Fund (EDF)
Contact: Elizabeth Skree
1875 Connecticut Ave., NW
Washington, DC 20009
Phone: 202.572.3382
Email: eskree@edf.org
- 54 LA Sea Grant
Contact: Roy Kron
103 Sea Grant Bldg.
Louisiana State University
Baton Rouge, LA 70803-7507
Phone: 225.578.6564
Email: rkron@lsu.edu
- 55 CEI (Coastal Environments Inc.)
Contact: Lynn Charles, Karen Wicker
1260 Main Street
Baton Rouge, LA 70802
Phone: 225.383.7455 Ext. 146
Email: lcharles@coastalenv.com
kwicker@coastalenv.com
- 56 Louisiana State University/Department of
Construction Management, LSU AgCenter (Making
Communities Safer)
Contact: Carol Friedland
Dept. of Construction Management
3128 Patrick F. Taylor Hall
Baton Rouge, LA 70803
Phone: 225.578.1155
Email: friedland@lsu.edu
- 57 Conrad Blucher Institute
Contact: Robin Ellis
6300 Ocean Drive NRC 2100
NRC 2100, Texas Corpus Christi
Phone: 361.825.3846
Email: robin.ellis@tamucc.edu
- 58 HESCO Bastion Inc
Contact: Aaron Ackley
47152 Conrad E. Anderson Drive,
Hammond, LA 70401
Phone: 985.345.7332
Email: aaron.ackley@hesco.com

Coastal, Riverine & Water Resources Engineering | Surveying & Mapping
Environmental Services | Oil & Gas Risk Management
High Definition Laser Scanning | Underwater Acoustic Services

Visit the FENSTERMAKER team at **Booth #39!**

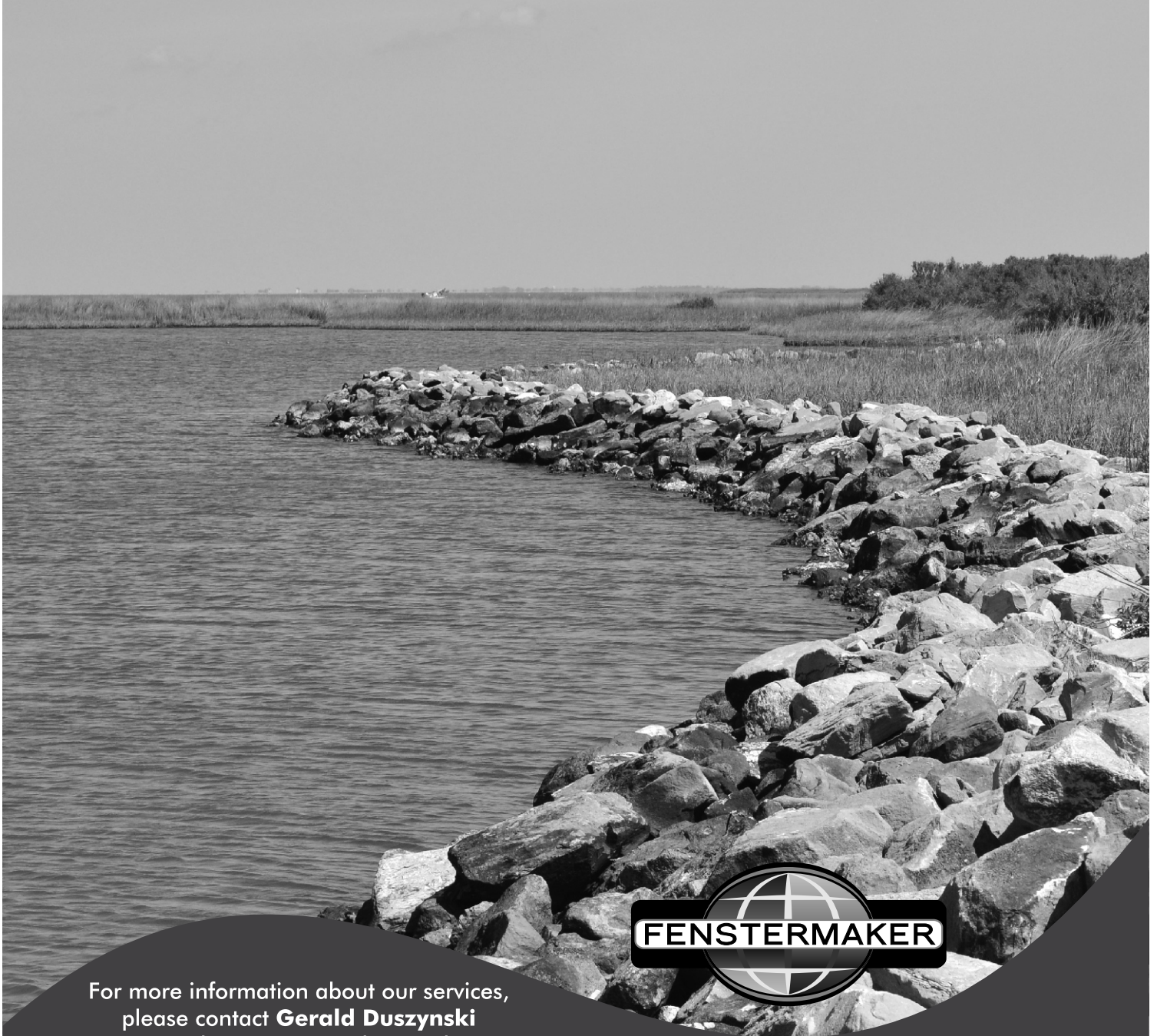

For more information about our services,
please contact **Gerald Duszynski**
Natural Resources Market Leader
gerald@fenstermaker.com or
225.344.6701
445 North Boulevard, Suite 601
Baton Rouge, Louisiana 70802



LOGA

LOUISIANA OIL & GAS ASSOCIATION



TETRA TECH

complex world | **CLEAR SOLUTIONS™**



CLEAN, SAFE WATER FOR A COMPLEX WORLD

Clean, safe water is essential to life. For more than 40 years Tetra Tech has helped to ensure that people around the world have access to safe, abundant water supplies; effective treatment of stormwater and wastewater; flood controls; and watershed protection. Tetra Tech provides essential services for every phase of the water cycle. Tetra Tech provides clear solutions in consulting, engineering, program management, construction management, and technical services worldwide.

www.tetratech.com

EXHIBITOR CONTACT INFORMATION CONT.

- | | |
|--|---|
| <p>60 Tranquility Nursery and Coastal Restoration
Contact: James Broadwell
2619 Tchoupitoulas Street
New Orleans, LA 70130
Phone: 504.309.2509
Email: broj@surfaceinc.com</p> <p>61 Texas A&M University Press
Contact: Kathryn Krol
John H. Lindseys Bldg, Lewis St. 4354 TAMU
College Station, TX 77843
Phone: 979.458.3984
Email: k-krol@tamu.edu</p> <p>62 The Nature Conservancy
Contact: Jennifer Browning
P.O. Box 4125
Baton Rouge, Louisiana 70821
Phone: 225.338.1040
Email: jrbrowning@tnc.org</p> <p>63 National Wildlife Federation (NWF)
Contact: David Muth
44 East Ave. Ste. 200
Austin, TX 78701
Phone: 512.610.7753
Email: haennm@nwf.org</p> <p>64 HNTB
Contact: Bryan Jones
10000 Perkins Rowe, Suite 640
Baton Rouge, LA 70810
Phone: 225.218.3648
Email: brjones@hntb.com</p> <p>65 Arcadis
Contact: Bill Hinsley
1100 Olive Way, Ste. 800
Seattle, WA 98101
Phone: 206.726.4741
Email: william.hinsley@arcadis-us.com</p> <p>66 Tetra Tech
Contact: Joe Cancienne
748 Main St., Ste. B
Baton Rouge, LA 70802
Phone: 225.383.1780
Email: joe.cancienne@tetrattech.com</p> <p>67 Ardaman
Contact: Donna Blumrich
316 Highlandia Drive,
Baton Rouge, LA 70810
Phone: 225.742.4790
Email: dblumrich@ardaman.com</p> | <p>68 Gulf United for Lasting Fisheries
Contact: Ashford Rosenberg
14001 River Road
New Orleans, LA 70131
Phone: 504.398.3188
Email: arosenberg@auduboninstitute.org</p> <p>70 Coastal Engineering Consultants (CEC)
Contact: Greg Grandy
5745 Essen Lane, Suite 200
Baton Rouge, LA 70810
Phone: 225.768.1982
Email: ggrandy@ceci-la.com</p> <p>71 Watershed Geosynthetics LLC
Contact: Bradford Cooley
11400 Atlantis Place, Suite 200
Alpharetta, GA 30022
Phone: 423.605.7477
Email: bcooley@watershedgeo.com</p> <p>72 Royal Engineers & Consultants
Contact: Randy Smith
601 Elysian Fields Ave
New Orleans, LA 70117
Phone: 504.309.4129
Email: rsmith@royalengineering.net</p> <p>73 HDR Engineering Inc
Contact: Samantha Harn
4635 Southwest Freeway, Ste 1000
Houston, TX 77027
Phone: 713.425.0170
Email: samantha.harn@hdrinc.com</p> <p>74 GEC
Contact: Amanda Roussel
8282 Goodwood Boulevard
Baton Rouge, Louisiana 70806
Phone: 225.612.4223
Email: aroussel@gecinc.com</p> <p>75 ConocoPhillips
Contact: Ordis J. (Buddy) Smith, III
806 Bayou Black Dr.
Houma, LA 70360
Phone: 985.853.3018
Email: Ordis.J.Smith@conocophillips.com</p> <p>76 Tierra Resources
Contact: Sarah Mack
1310 Saint Andrew St. Suite 1
New Orleans, LA 70130
Phone: 504.339.4547
Email: sarahmack@tierraresourcesllc.com</p> |
|--|---|

EXHIBITOR CONTACT INFORMATION CONT.

- 77 CSRS
Contact: Travis Woodard
6767 Perkins Road, Suite 200
Baton Rouge, LA 70808
Phone: 225.769.0546
Email: woodard@csrsonline.com
- 78 Big River Industries, Inc.
Contact: Jeff Speck
900 Ashwood Parkway Suite 500
Atlanta, Georgia 30338
Phone: 678.461.2830
Email: jeff.speck@riverlite.com
- 80 Nat'l Audubon Society
Contact: Doug Meffert
6160 Perkins Road Suite 15
Baton Rouge, LA 70808
Phone: 225.768.0820
Email: dmeffert@audubon.org
- 81 Bertucci Contracting Company, LLC
Contact: Chris Francioni
Po Box 10582
New Orleans, LA 70181
Phone: 504.473.9237
Email: chrissf@bertuccicorp.com
- 82 CWPPRA
83 CWPPRA
84 CWPPRA
Contact: Susan Bergeron
United States Geological Survey
National Wetlands Research Center
700 Cajundome Blvd.
Lafayette, LA 70506
Phone: 337.266.8623
Email: bergerons@usgs.gov
- 85 Stanley Consultants
Contact: Brant Richard
721 Government Street, Suite 302
Baton Rouge, LA 70802
Phone: 225.387.2422
Email: richardbrant@stanleygroup.com
- 86 Wayfarer Environmental Technologies, LLC
Contact: Michael Turley
PO Box 11937
New Iberia, LA. 70563
Phone: 225.627.1365
Email: mike@wayfarertech.com
- 87 SHORE|LINKS, A Product of Delta Land Services, LLC
Contact: Burt Brumfield
1090 Cinclare Drive
Port Allen, LA 70767
Phone: 225.343.3900
Email: burt@deltaland-services.com
- 88 Ellicott Dredges LLC
Contact: Steve Miller
1425 Wicomico Street
Baltimore, MD 21230
Phone: 410.545.0261
Email: SMiller@dredge.com
- 90 Coast Builders Coalition
Contact: Scott Fitzpatrick
8440 Jefferson Hwy, Ste 301
Baton Rouge, LA 70809
Phone: 225.929.7033
Email: Scott@coastbuilderscoalition.org
- 91 AECOM Tom Cancienne
Contact: 1555 Poydras St Suite 1860
New Orleans, Louisiana 70112
Phone: 504.592.3582
Email: thomas.cancienne@aecom.com
- 94 Dynamic Solutions
Contact: Christopher Wallen
6421 Deane Hill Dr., Ste. 21
Knoxville, TN 37919
Phone: 225.335.4524
Email: cmwallen@dslc.com
- 95 America's Wetland Foundation
Contact: Lisa L. Noble
365 Canal Place, Suite 1475
New Orleans, LA 70130
Phone: 562.429.3821
Email: lnoble@americaswetland.com
- 96 Aero-Data Corporation LLC
Contact: Randall Grip
8245 YMCA Plaza Dr.
Baton Rouge, La 70810
Phone: 225.767.5725
Email: rgrip@aero-data.com
- 97 Chevron
Contact: Sarah Hughes
ADDRESS
Address
Phone: 985.249.0124
Email: Sarah.Huges@chevron.com

-
- | | | | |
|-----|---|-----|---|
| 98 | Entergy
Contact: Kristin Batulis
Address
Address
Phone: 985.725.7635
Email: kBatulis@entergy.com | n/a | BKI (Burk Kleinpeter)
Contact: Bruce Badon
4176 Canal Street
New Orleans, LA 70119
Phone: 504.486.5901
Email: bbadon@bkiusa.com |
| 99 | Sigma Consulting Group, Inc.
Contact: Michael Somme
10305 Airline Highway
Baton Rouge, LA 70816
Phone: 225.298.0800
Email: msomme@sigmacg.com | n/a | Great Lakes Dock and Dredging (GLDD)
Contact: Bill Hanson
2122 York Road
Oak Brook, IL 60523
Phone: 630.574.3019
Email: WHHanson@gldd.com |
| 100 | RES (Resource Environmental Solutions)
Contact: Russ Krauss
412 N. 4th St, #300
Baton Rouge, LA 70802
Phone: 713.986.9222
Email: russ@res.us | n/a | LOGA
Contact: Cece Richter
PO Box 4069
Baton Rouge, LA 70821
Phone: 225.388.9525
Email: cece@loga.la |
| 101 | Rand Gulf States Policy Institute
Contact: Gary Cecchine
650 Poydras Street, Suite 1400
New Orleans, LA 70130
Phone: 504.299.3432
Email: cecchine@rand.org | n/a | Stantec
Contact: Mike McGaugh
500 Main Street
Baton Rouge, LA 70801
Phone: 225.765.7400
Email: mike.mcgough@stantec.com |
| 102 | Professional Service Industries, Inc. (PSI)
Contact: Georgina San Martin
724 Central Avenue
Jefferson, LA 70121
Phone: 504.733.9411 x 117
Email: georgina.sanmartin@psiusa.com | n/a | SSA Consultants
Contact: Christel Slaughter
9331 Bluebonnet Boulevard
Baton Rouge, LA 70810
Phone: 225-769-2676
Email: cslaughter@consultssa.com |
| 103 | W.F. Baird & Associates Ltd.
Contact: Jacci Meier
2981 Yarmouth Greenway Drive
Madison, Wisconsin 53711
Phone: 608.273.0592
Email: jmeier@baird.com | | |

Norco Manufacturing Complex

MOTIVA
ENTERPRISES LLC



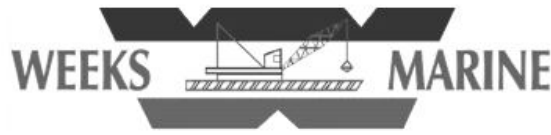

TEAMWORK

Weeks Marine — a full-service provider for Dredging, Construction & Marine Services

Founded in 1919, Weeks Marine is a capable and experienced provider for all your marine contracting requirements, including:

- Dredging, Beach Nourishment, and Land Reclamation
- Marine Construction for Bid/Build and EPC projects, for the Public and Private Sectors
- Marine Services including Heavy Lift, Stevedoring, Towing, Equipment Charters and Rentals

Weeks Marine has an exceptional record for building complex projects through Teamwork. This means Teamwork within the Weeks organization, with our Clients and Engineering counterparts. Teamwork begins at project inception and continues through project completion. At Weeks, Teamwork also means a commitment to a safe working environment for our employees and others through our Incident & Injury Free culture.

For more information regarding our services, please contact:

- Dredging - Chuck Broussard - crbroussard@weeksmarine.com
- Construction - Andrew Swank - acswank@weeksmarine.com
- Marine Services - Jason Marchioni - jlmarchioni@weeksmarine.com

www.WeeksMarine.com



Local knowledge counts.

At URS, we believe that the depth of your knowledge determines the level of your success. And the more local knowledge you possess, the better equipped you are to deliver solutions that work. For more than 40 years we have delivered in-house expertise on a wide range of coastal projects throughout Louisiana. Today, through our offices in Baton Rouge, Metairie, New Orleans, Lake Charles, and Shreveport, we are ready to meet the challenges of the present—and the future. Which is why, when it comes to coastal engineering and protection, environmental restoration, and hydraulic and hydrologic modeling, more people are turning to us to get it done. We are URS.

*7389 Florida Boulevard, Suite 300, Baton Rouge, LA 70806
225.922.5700*

URS

FEDERAL
OIL & GAS
INFRASTRUCTURE
POWER
INDUSTRIAL

URS.COM

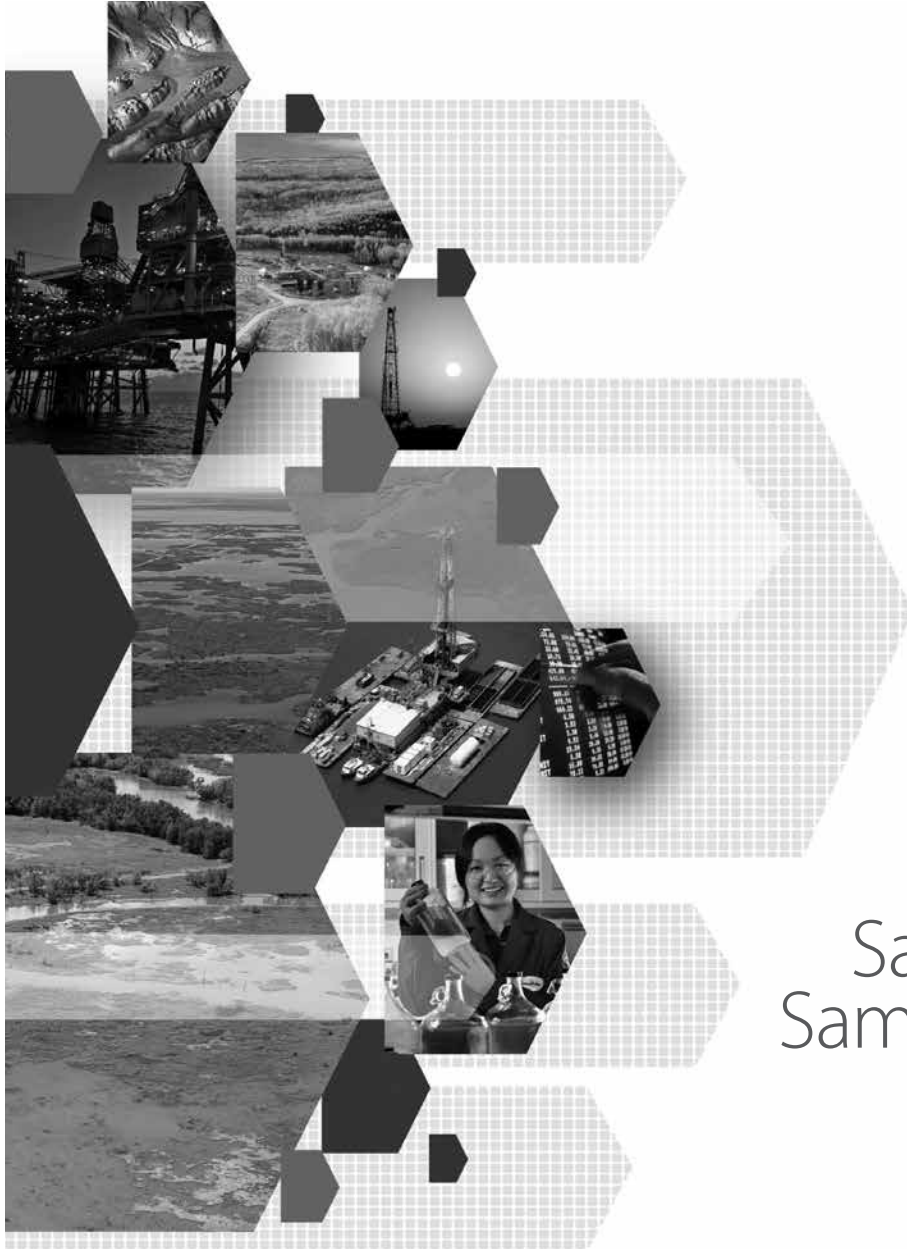

Same name.
Same values.
Local Pride.

At ConocoPhillips, we're building on our SPIRIT Values – safety, people, integrity, responsibility, innovation and teamwork – to create a company like no other. A company with global reach and strong ties to the local communities where we operate. As the largest private wetlands owner in Louisiana and the United States, ConocoPhillips is proud to call Louisiana home.

As an industry leader now exclusively focused on exploration and production, we are pioneering a new standard of excellence. And even as we embark on this new journey, the way we do business, our pride as a Louisiana citizen – our spirit – is staying the same.

www.conocophillips.com

NOTES

This image shows a blank sheet of white paper with horizontal ruling lines. The lines are evenly spaced and run across the width of the page. There are no margins, text, or other markings on the paper.

[illegible]

NOTES

[illegible]

NOTES

[illegible]



**Environmental Defense Fund
is a leading national nonprofit
organization that creates
transformational solutions to
the most serious environmental
problems.**

To learn more, visit us at edf.org



Nourishing vital crops
and strengthening local communities.

At Mosaic, our mission is to help the world grow the food it needs. We're committed to safe operations, as well as to helping nurture and enhance our surrounding communities here in the River Parishes. As our work continues, we devote ourselves to nourishing not only the crops that feed us all, but also the communities that shape and enrich our lives every day.

Mosaic
mosaicco.com/la



**Oil & Gas Well Locations
Pipeline Surveys
Hazard Surveys
Hydrographic Surveys
Regulatory Compliance
Environmental Consulting
Geographic Information
Systems**

985-879-2731

www.mphinc.com

Houston, TX • Baton Rouge, LA • Houma, LA • Clinton, NJ • San Antonio, TX



**Restore
or
Retreat**

Support the Solution!

The Barataria and Terrebonne Basins are ground-zero in Louisiana's fight against coastal land loss with 60 percent of the state's total land loss. That's why coastal advocacy group Restore or Retreat is working aggressively on long-term, sustainable solutions to save our coast and our culture, such as Mississippi River Delta Management, existing and planned freshwater and sediment diversions, long distance pipeline sediment conveyance, and better utilization of the Atchafalaya resources into the Terrebonne Basin.

To learn more, visit:
www.Restore or Retreat.org



HNTB

100

YEARS OF
INFRASTRUCTURE
SOLUTIONS

hntb.com